

Bayfield County Forestry & Parks Department

Estimated Volumes

Foresters: Holmes & L. Neitzel	Twp: 47N	Range: 9W	Sec: 8 & 9			
Acres: 21	Township: Hughes			Species	Roundwood (Cords)	Whole-Tree (Tons)
Soil: Sandy Loam	Compartment: 104, 105	Stand: 2, 10	Aspen			
Topography: Moderate Slopes	Tract Number: 03-14	Reforestation Code: RE-1	Mixed Hardwood*	268	869	
Contract Number:			*76% Red Maple, 23% White Birch, 1% Other Hardwood			

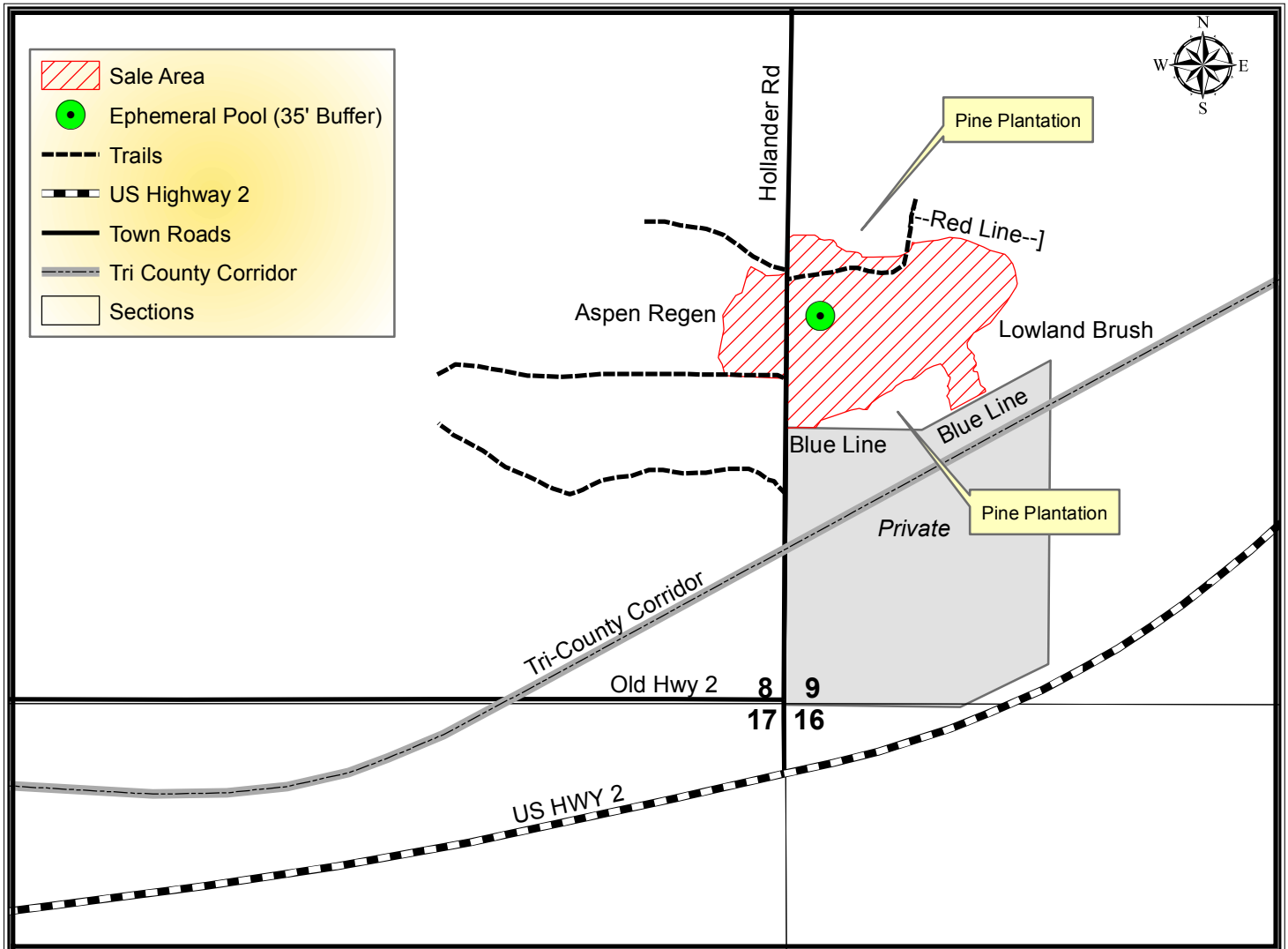

Harvest Requirements:

- This sale is being sold on a Ticket Scale Basis.
- The sale boundaries are formed by red and blue paint line, by Hollander Rd, by the 2 trails running west off Hollander Rd, and by distinct timber type changes (aspen regen in the west, lowland brush in the east).
- An ephemeral pool sits just east of Hollander Rd in the middle of the stand. Do not harvest any trees within 35 feet of the edge of the pool.
- If the whole-tree harvested, 1 in 10 tops less than or equal to 4" in diameter must be left scattered across the site.
- No equipment or felled trees may cross the blue paint line
- **Prescription:** LEAVE all oak. LEAVE all conifers. HARVEST all other merchantable hardwoods. SEVER all non-merchantable hardwood stems 2" in diameter and greater (except oak).
- Leave all snags except individuals that pose a safety hazard
- Decking of wood along town roads will not be allowed without permission from Bayfield County.
- Do not damage any survey monuments.
- To comply with the Best Management Practices for Invasive Species: Prior to moving equipment onto or off of the sale area, scrape or brush soil and debris from exterior surfaces of the logging equipment.
- This contract requires County authorization for all road/landing construction and places a number of other requirements on road construction and closure. (refer to Sec. 17)