

# Bayfield County Forestry & Parks Department

Forester: Joanna Delegan	Twp: 46N	Range: 9W	Sec: 33	Estimated Volumes: <table border="1"> <thead> <tr> <th>Species</th> <th>4" Cords</th> <th>WT Tons</th> </tr> </thead> <tbody> <tr> <td>Red Pine*</td> <td>828</td> <td>1732</td> </tr> <tr> <td>Jack Pine**</td> <td>22</td> <td>43</td> </tr> </tbody> </table> *Avg. diameter of red pine: 16" dbh **Jack pine volume may include trace amounts of mixed hardwood.	Species	4" Cords	WT Tons	Red Pine*	828	1732	Jack Pine**	22	43
Species	4" Cords	WT Tons											
Red Pine*	828	1732											
Jack Pine**	22	43											
Acres: 27	Township: Barnes – North												
Soil: Sand	Compartment: 152	Stand: 13											
Regen Code: Artificial Regeneration	Tract Number: 07-14												
Topography: flat	Contract Number:												
Scale: 4 in. = 1 mile													

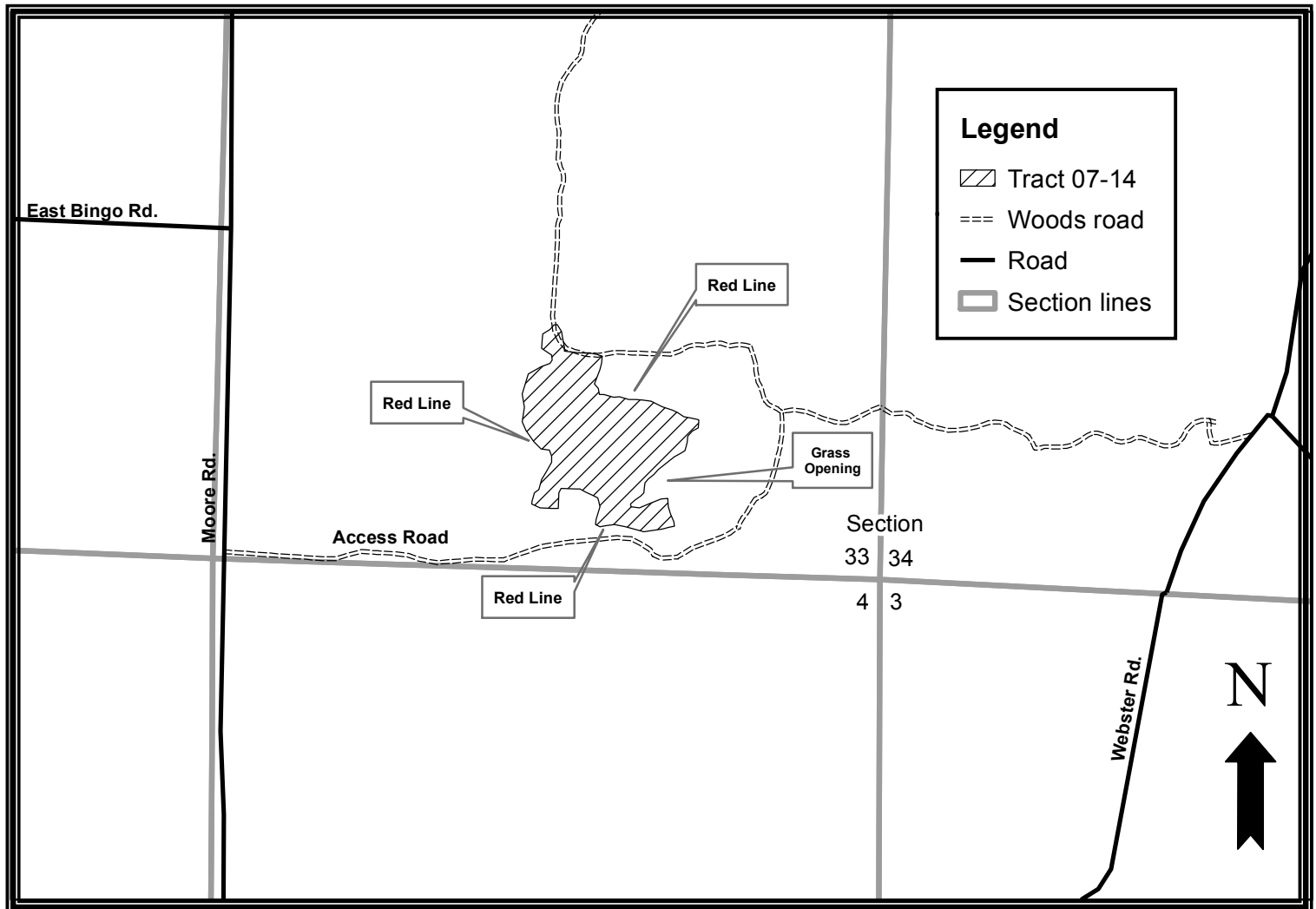

## Harvest requirements:

- Sale is being sold on a ticket scale basis. Whole-tree harvesting and/or utilization of tops less than 4" diameter will be allowed.
- If sale is whole tree harvested, 1 in 10 tops <4" in diameter must be left scattered across the site.
- Sale boundaries consist of red paint lines or an abrupt change in timber type.
- Cut all trees within the sale area down to 2 inches DBH.
- Prior to moving equipment to and from the sale area, scrape soil and debris from exterior surfaces.
- This contract requires County authorization for all road/landing construction, and places a number of other requirements on road construction and closure.
- Decking of wood along town roads will not be allowed without permission from Bayfield County.
- Do not damage any survey monumentation.
- Harvested pine cannot be kept on the Bayfield County Forest for more than three weeks from May 1<sup>st</sup> to August 31<sup>st</sup>.