

# Bayfield County Forestry & Parks Department

|                                      |                        |                             |         |
|--------------------------------------|------------------------|-----------------------------|---------|
| Foresters:<br>Amman, Neitzel, Holmes | Twp: 47N               | Range: 9W                   | Sec: 15 |
| Acres:<br>78                         | Township: Hughes       |                             |         |
| Soil:<br>Sand                        | Compartment:<br>108    | Stand:<br>12                |         |
| Topography:<br>Slightly Rolling      | Tract Number:<br>36-14 | Reforestation Code:<br>RE-2 |         |
| Scale:<br>1 inch = 1/4 mile          | Contract Number:       |                             |         |

## Estimated Volumes

| Species     | Roundwood |
|-------------|-----------|
|             | (Cords)   |
| Scrub Oak   | 498       |
| Aspen       | 76        |
| Red Maple   | 430       |
| White Birch | 119       |
| Spruce/Fir  | 16        |

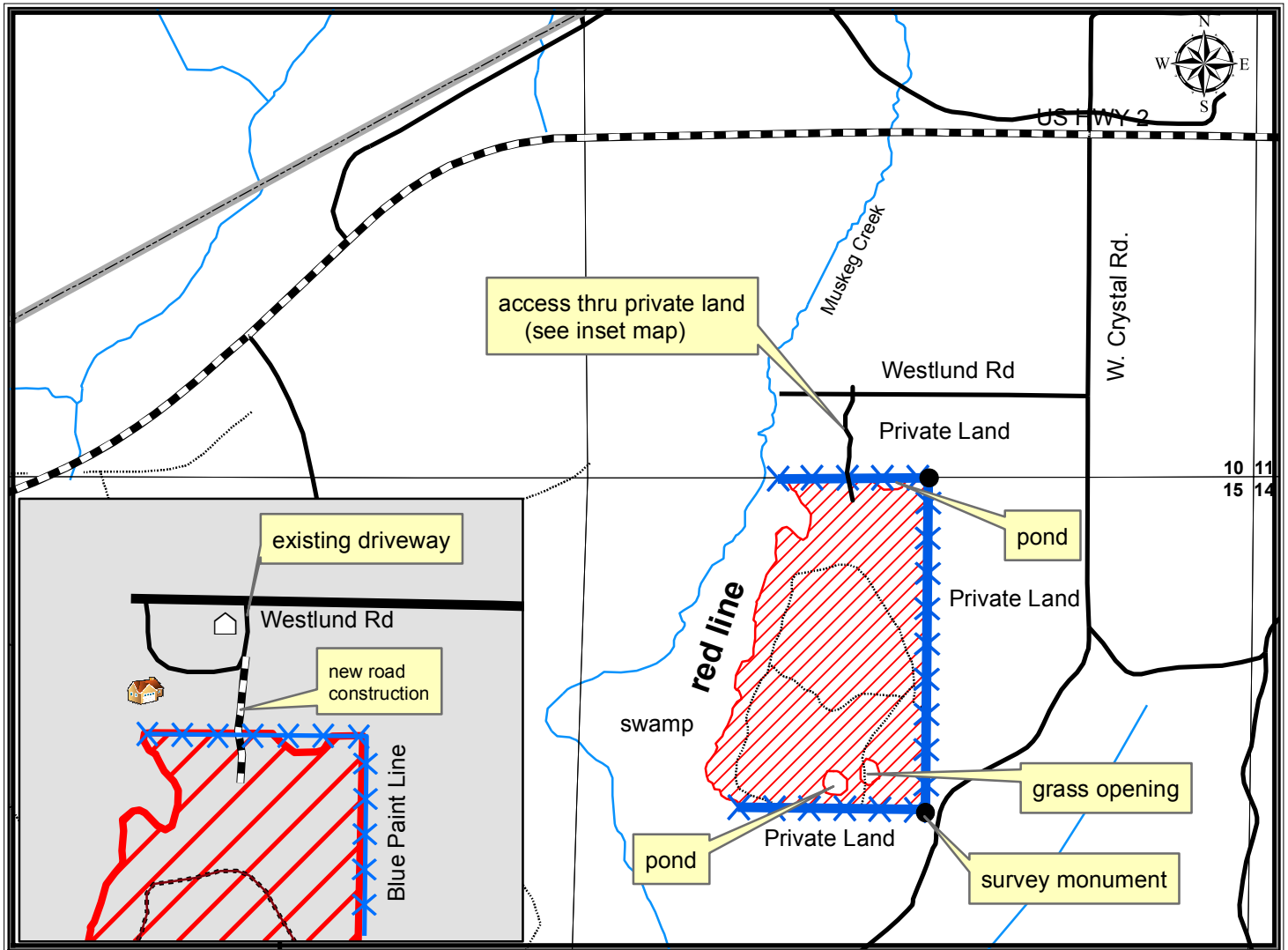

### Harvest Requirements:

- This sale is being sold on a Ticket Scale Basis.
- The sale boundaries are formed by red and blue paint line. The west border is red paint. The north, east, and southern boundaries are painted blue.
- The blue paint line marks the border with private land. No trees or equipment may cross the blue painted tree except where access has been secured.
- Access has been secured by Bayfield County to use an existing driveway adjacent to his metal garage (100 yds) and to build new road off the driveway into county forest land (100 yds). Sale administrator will meet with landowner and contractor prior to construction to review approved use and construction of roads on private property. Contractor is responsible for the maintenance of the driveway. See map for details.
- There is gravel on the existing driveway. If that gravel is lost or buried the contractor must bring the road back to its original condition, as determined by Bayfield County.
- Road will be bermed between county and private ownership upon completion of the sale. Upon completion of the sale the county will seed the new road portion located on private land.
- **Prescription:** LEAVE all red and white pine and purple painted trees. HARVEST all other merchantable hardwoods and merchantable balsam and spruce. SEVER all non-merchantable hardwood stems 2" in diameter and greater.
- Whole tree harvesting and/or utilization of tops (less than 4" diameter) will not be allowed.
- **No harvesting will be allowed from October thru the end of December 31.**
- **No hauling or harvesting will be allowed between the hours of 10pm and 6am.**
- Leave all snags except individuals that pose a safety hazard
- Do not damage any survey monuments.
- To comply with the Best Management Practices for Invasive Species: Prior to moving equipment onto or off of the sale area, scrape or brush soil and debris from exterior surfaces of the logging equipment.
- This contract requires County authorization for all road/landing construction and places a number of other requirements on road construction and closure. (refer to Sec. 17)