

# Bayfield County Forestry & Parks Department

Forester: Andrew O'Krueg			Compartment: 58	Stand: 37	Tract Number: <b>53-19</b>
Twp: 50N	Range: 6W	Sec: 34	Township: Bell	Contract Number:	
Topography: Gently Rolling			Reforestation Code: N/A	Soil: Loamy Sand	Acres: <b>67</b>

Estimated Volumes				*Approx 98% Jack Pine and 2% Balsam Fir
Species	4" Roundwood (Cords)	Whole Tree (Tons)	Sawlogs (MBF)	Red Pine = 7" - 8" average diameter
Red Pine	832			<b>Special Restrictions:</b> >Pine must be hauled within 3 weeks from May 1st to August 31st.
Jack Pine*	21			
Aspen	10			

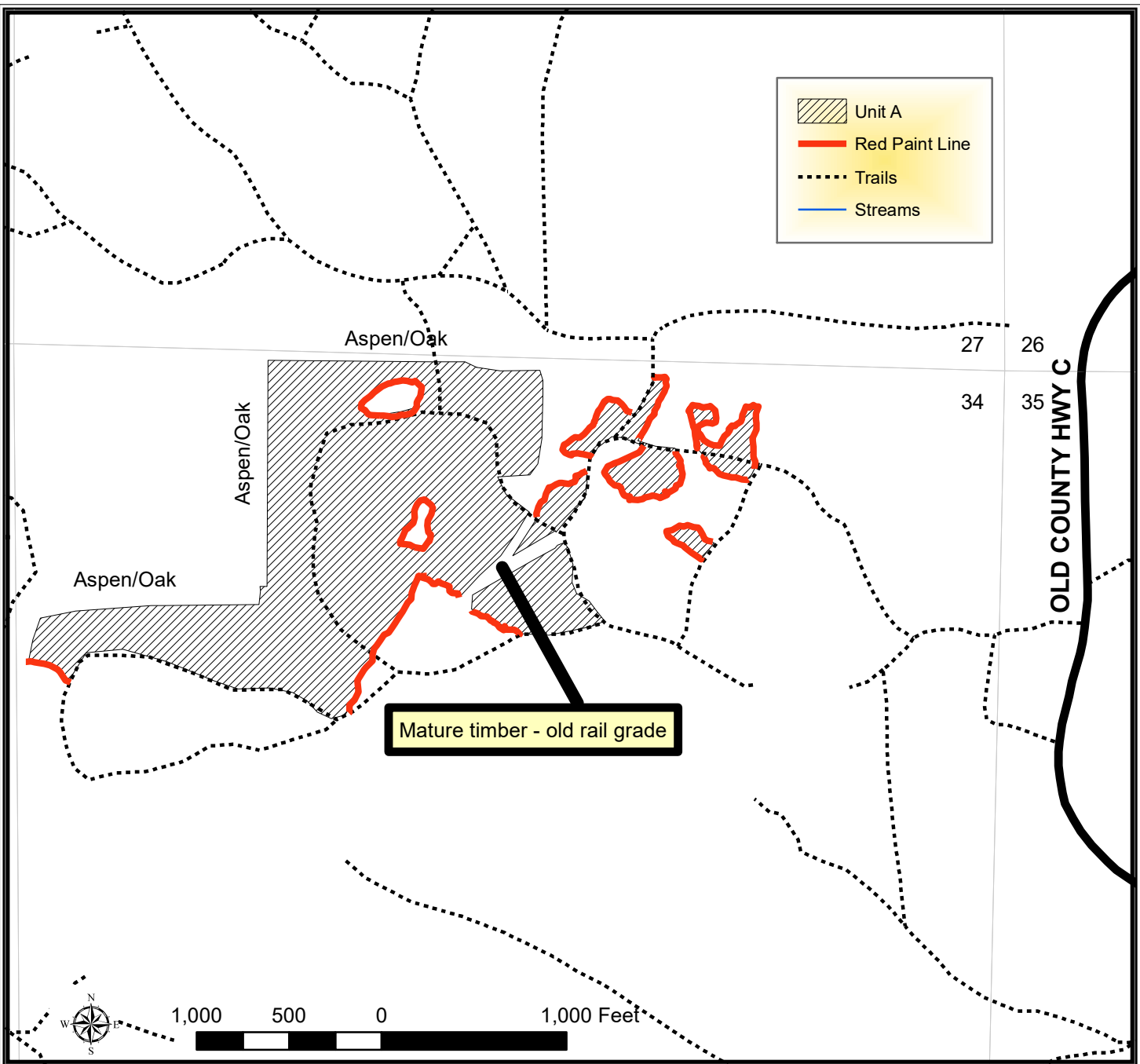

## TRACT 53-19 – HARVEST REQUIREMENTS

The following terms and conditions supplement those provided in the Bayfield County Timber Sale Contract.

### A. PRESCRIPTION:

1. Harvest unit A has a thinning prescription with an estimated average residual basal area of 114 ft<sup>2</sup>.

### B. HARVEST REQUIREMENTS:

1. In unit A, harvest all orange marked red pine and all jack pine, balsam fir, and aspen 4" and greater.
2. In unit A, leave all white pine, spruce, birch, oak, and unmarked red pine.

### C. OPERATIONAL REQUIREMENTS AND SEASONAL RESTRICTIONS:

1. Harvest pine cannot be kept on the Bayfield County Forest for more than three weeks from May 1<sup>st</sup> to August 31<sup>st</sup>.

### D. ACCESS AND ROADS:

1. This contract requires County authorization for all road/landing construction and places a number of other requirements on road construction and closure.
2. Decking of wood along town roads will not be allowed without permission from Bayfield County.

### E. OTHER:

1. To comply with Best Management Practices for Invasive Species: Prior to moving equipment onto or off the sale area, scrape or brush soil and debris from exterior surfaces to the extent practical.

