

Bayfield County Forestry & Parks Department

Forester: Andrew O'Krueg			Compartment: 68	Stand: 3	Tract Number: 14-18
Twp: 49N	Range: 5W	Sec: 5	Township: Bayview	Contract Number:	
Topography: Gently Rolling, Moderate Slopes			Reforestation Code: PJ - Seed	Soil: Sand, Loamy Sand	Acres: 81

Estimated Volumes				*Approx. 98% Jack Pine, 2% Other Conifer
Species	4" Roundwood (Cords)	Whole Tree (Tons)	Sawlogs (MBF)	
Jack Pine*	1421	4139		** Approx. 80% Maple, 10% Oak, 9% White Birch, 1% Other Hardwood
Aspen	116	336		
Red Maple**	51	163		
				Special Restrictions:

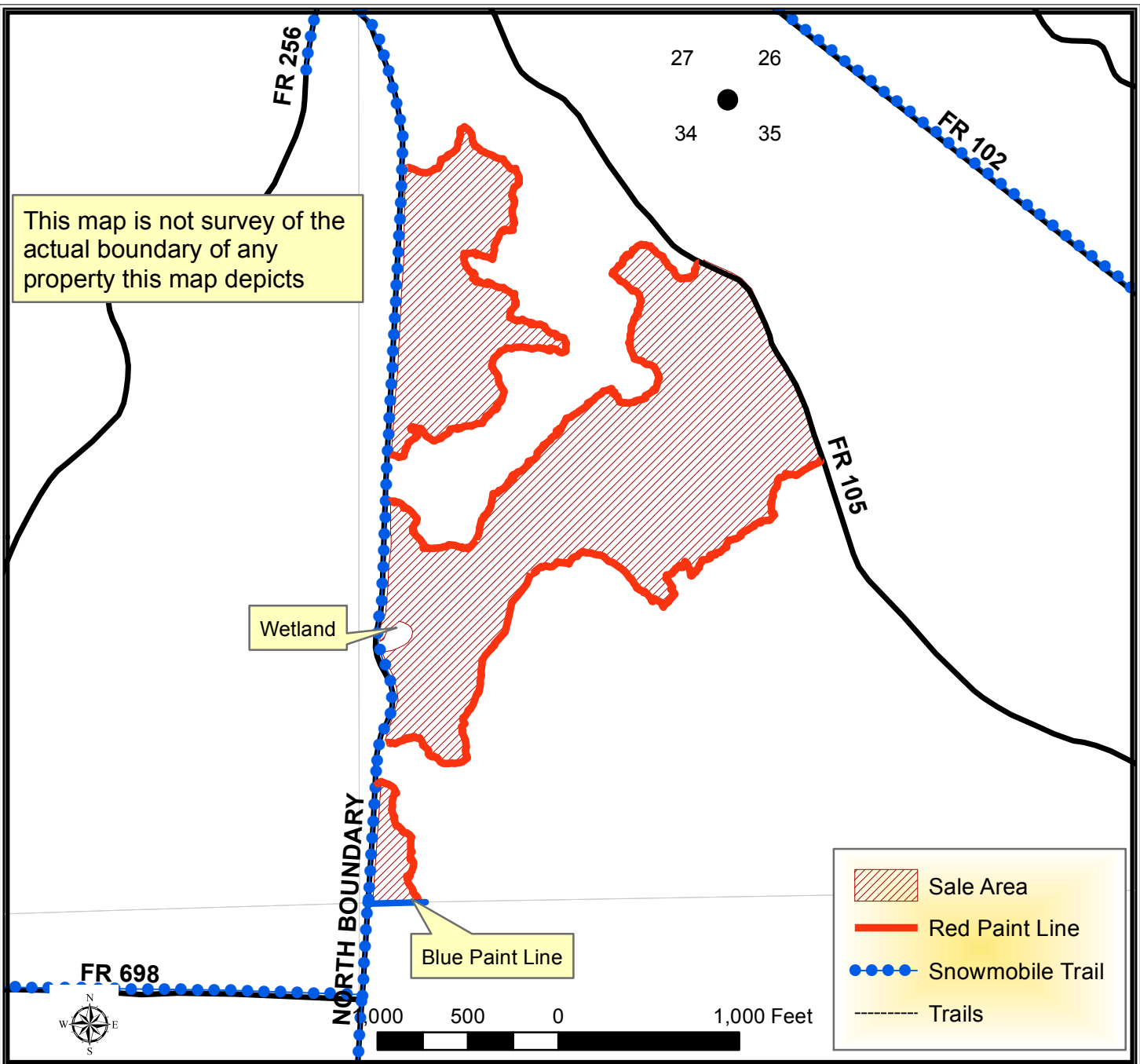

TRACT 14-18 – HARVEST REQUIREMENTS

The following terms and conditions supplement those provided in the Bayfield County Timber Sale Contract.

A. PRESCRIPTION:

1. Harvest unit 1 has a clearcut prescription with an estimated average residual basal area of 0 ft².

B. HARVEST REQUIREMENTS:

1. In unit 1, harvest all conifer and hardwood stems 2" and greater.
2. In unit 1, leave all hardwood stems within 15 feet of the wetland indicated on the map.

C. OPERATIONAL REQUIREMENTS AND SEASONAL RESTRICTIONS:

1. Sale boundaries consist of red paint line, blue paint line, roads, or a wetland.
2. No equipment or trees may be felled within the wetland area indicated on the map.
3. If harvest will utilize the whole tree, 1 in 10 tops must be left scattered throughout the sale.
4. Harvested pine cannot be kept on the Bayfield County Forest for more than three weeks from May 1st to August 31st.
5. The blue paint line indicates private property. No equipment or felled trees may cross the line.

D. ACCESS AND ROADS:

1. During winter harvesting the snowmobile trail must be kept unobstructed and in a packed snow condition. The purchaser must ensure that harvesting and hauling operations will not create a safety hazard to snowmobiles.
2. This contract requires County authorization for all road/landing construction and places a number of other requirements on road construction and closure.
3. Decking of wood along town roads will not be allowed without permission from Bayfield County.

E. OTHER:

1. To comply with Best Management Practices for Invasive Species: Prior to moving equipment onto or off the sale area, scrape or brush soil and debris from exterior surfaces to the extent practical.

