

Bayfield County Forestry & Parks Department

Forester: Caleb E. Brown			Compartment: 106 & 109	Stand: 38 & 6	Tract Number: 23-18
Twp: 47N	Range: 9W	Sec: 2 & 11	Township: Hughes	Contract Number:	
Topography: Gentle Rolling & Moderate Slopes			Reforestation Code: Natural	Soil: Loamy Sand	Acres: 73

Estimated Volumes				*Approximately 91% Scrub Oak, 8% Red Maple, and 1% Other Hardwoods. ** Approximately 56% Jack Pine and 44% Other Conifer.
Species	4" Roundwood (Cords)	Whole Tree (Tons)	Sawlogs (MBF)	
Scrub Oak*	818	0	0	Other No Whole Tree Harvesting
Aspen	79	0	0	
Jack Pine**	20	0	0	

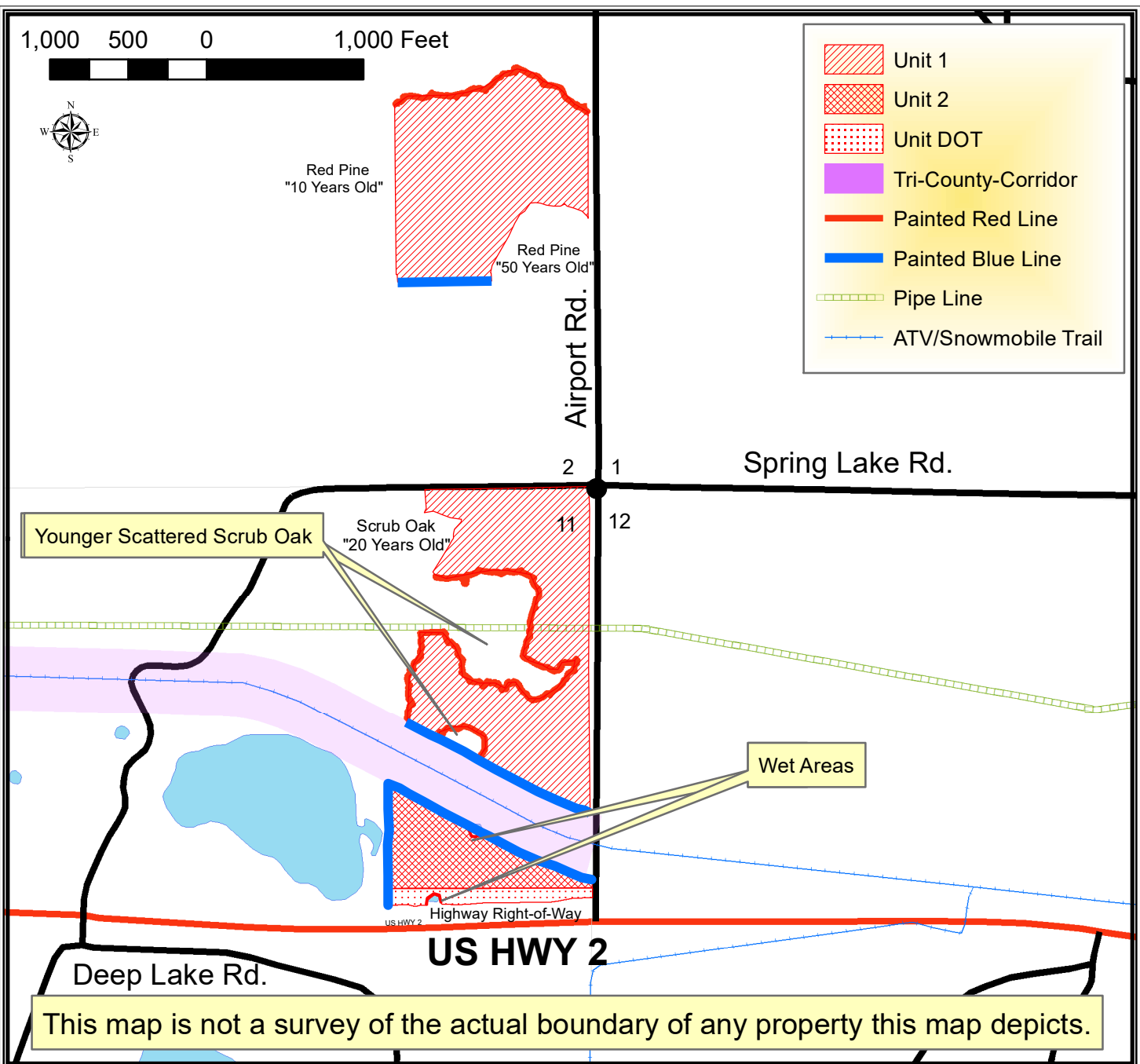

TRACT 23-18 – HARVEST REQUIREMENTS

The following terms and conditions supplement those provided in the Bayfield County Timber Sale Contract.

A. PRESCRIPTION:

1. Harvest units 1 & 2 are coppice prescriptions with an estimated average residual basal area of 8 ft².
2. Harvest unit DOT is a coppice prescription with an estimated average residual basal area of 0 ft².

B. HARVEST REQUIREMENTS:

1. In unit 1, harvest all hardwood and jack pine stems 4 inches in diameter and greater.
2. In unit 2, harvest all hardwood and jack pine stems 2 inches in diameter and greater.
3. In units 1 & 2, do not harvest other conifers and purple marked oak.
4. In unit DOT, harvest all stems 2 inches in diameter and greater.

C. OPERATIONAL REQUIREMENTS AND SEASONAL RESTRICTIONS:

1. Sale boundaries include red paint line, blue paint line and abrupt timber type changes to red pine plantation and young scrub oak.
2. Whole tree harvesting and/or utilization of tops ($\leq 4''$ diameter) will not be allowed.
3. Currently no boundary line marked between unit 2 and unit DOT. Contractor can use Avenza Maps to determine boundary line or can apply the unit DOT prescription for the 75 feet north of highway right-of-way.
4. The Blue line indicates private property. No equipment or felled trees may cross the line.
5. Do not damage any survey monumentation.

D. ACCESS AND ROADS:

1. This contract requires County authorization for all road/landing construction and places a number of other requirements on road construction and closure.
2. Decking of wood along town roads will not be allowed without permission from Bayfield County.
3. If the Natural Gas pipeline needs to be crossed, Diggers hotline must mark the line and the pipeline company must be contacted prior to crossing. The pipeline company may place conditions on crossing the line. In the past they have requested that soil lift be used where the road crosses the line.

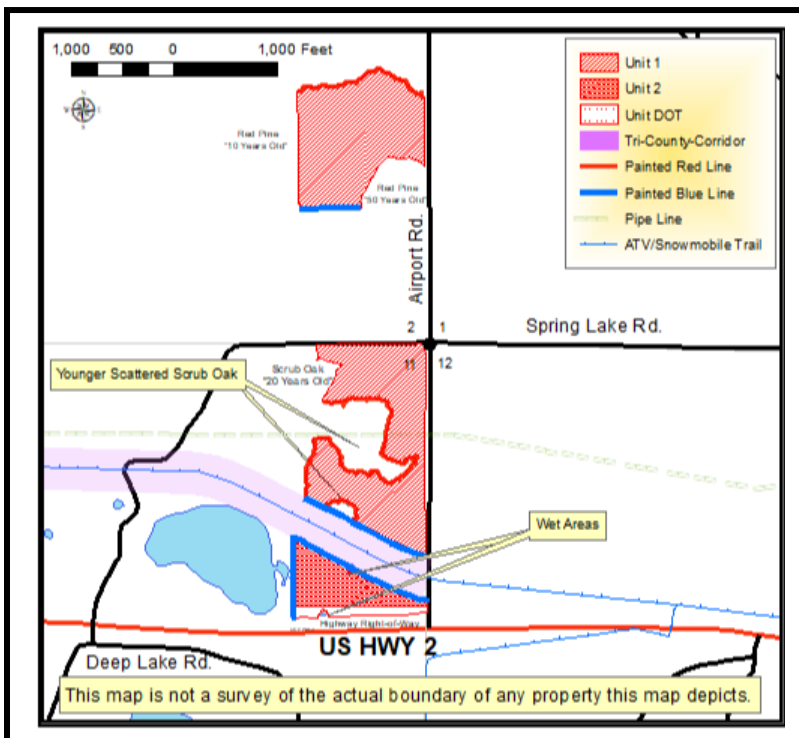

4. An underground utility line runs alongside the west side of Airport Rd. between the road and the harvest units. The Contractor will be responsible for contacting Diggers Hotline at least three (3) days prior to performing any road construction or work. It is the contractor's responsibility to ensure safe harvesting conditions when operating within the vicinity of the underground line and will take all precautions to avoid damage to buried and above ground utilities.

E. OTHER:

1. To comply with Best Management Practices for Invasive Species: Prior to moving equipment onto or off the sale area, scrape or brush soil and debris from exterior surfaces to the extent practical.
2. A permit is required to work within the DOT ROW. Permit must be filled out by the contractor prior to harvesting. There is no cost to this permit. Bayfield County will facilitate the handling of this permit. Contractor must provide the County 30 days advanced notice prior to moving into the job to allow for the completion of the permit.

3. Approximately 3 acres is located within the DOT right of way. This land is not part of the county forest and does not contain wood that is certified. An estimated 47 cords of non-certified wood is contained within this portion of the sale. The county will supply modified haul tickets for transporting the estimated volume of non-certified wood harvested from the DOT right of way.