

Bayfield County Forestry & Parks Department

Forester: Neitzel			Compartment: 104,105,107	Stand: 3,11,3	Tract Number: 33-18
Twp: 47N	Range: 9W	Sec: 8,9,17	Township: Hughes	Contract Number:	
Topography: Gentle Rolling			Reforestation Code: N/A	Soil: Sand and Sandy Loam	Acres: 12

Estimated Volumes				*Average Diameter is 12"
Species	4" Roundwood (Cords)	Whole Tree (Tons)	Sawlogs (MBF)	
Red Pine*	177	504		

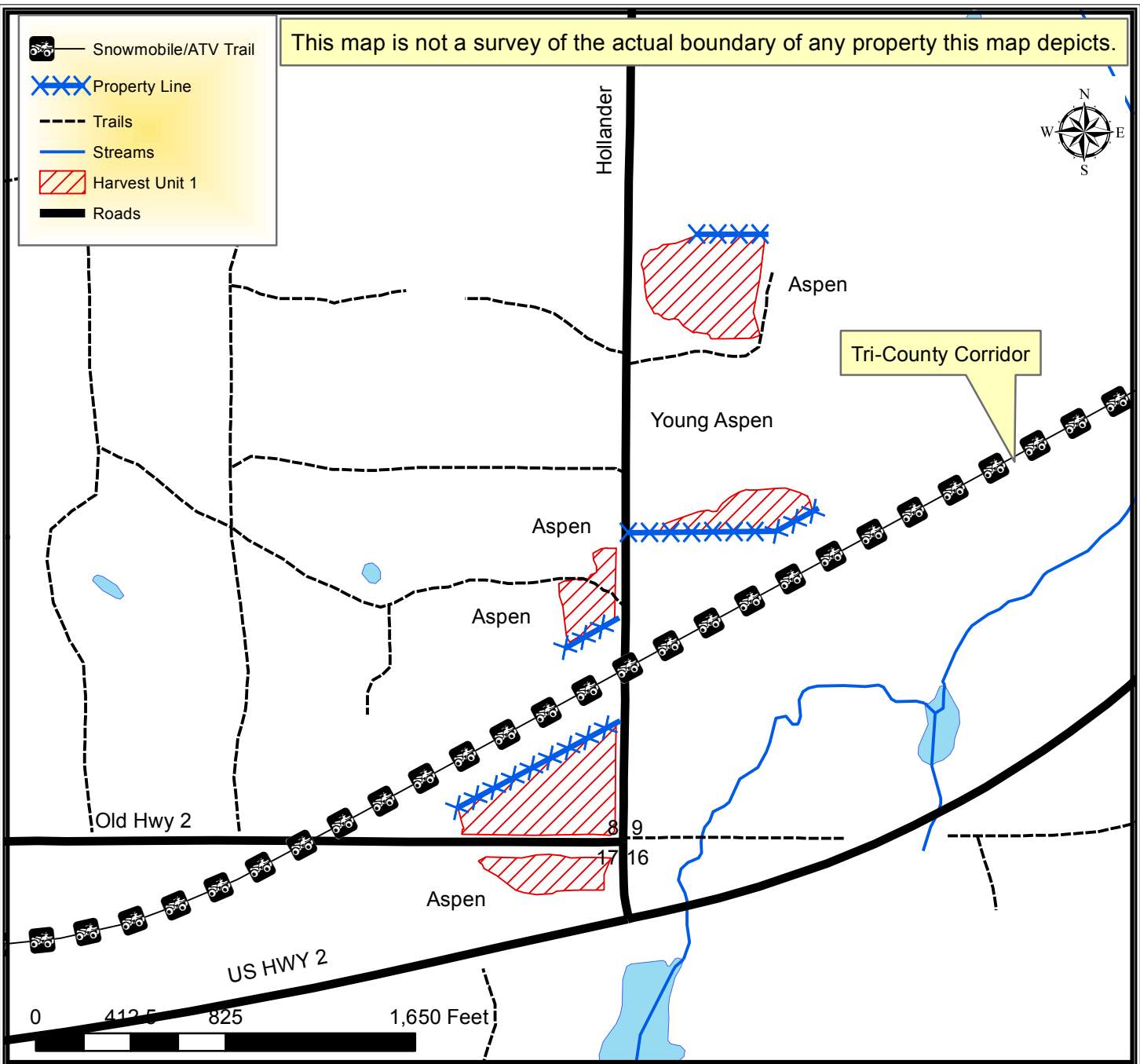

TRACT 33-18 – HARVEST REQUIREMENTS

The following terms and conditions supplement those provided in the Bayfield County Timber Sale Contract.

A. PRESCRIPTION:

1. Harvest unit 1 has a thinning prescription with an estimated average residual basal area of 113 ft².

B. HARVEST REQUIREMENTS:

1. Harvest all orange marked trees.

C. OPERATIONAL REQUIREMENTS AND SEASONAL RESTRICTIONS:

1. Sale boundaries consist of timber type changes to aspen, roads or blue line.
2. Harvested pine cannot be kept on the Bayfield County Forest for more than three weeks from May 1st to August 31st.
3. Do not damage any survey monumentation.
4. If harvest will utilize the whole tree, 1 in 10 tops must be left scattered throughout the sale.

D. ACCESS AND ROADS:

1. During winter harvesting snowmobile trails must be kept unobstructed and in a packed snow condition. The purchaser must ensure that harvesting and hauling operations will not create a safety hazard to snowmobiles. Avoid damage to signs and trail markers.
2. No hauling is allowed on the Snowmobile/ATV trail (Tri-County Corridor).
3. This contract requires County authorization for all road/landing construction and places a number of other requirements on road construction and closure.
4. Decking of wood along town roads will not be allowed without permission from Bayfield County.

E. OTHER:

1. To comply with Best Management Practices for Invasive Species: Prior to moving equipment onto or off the sale area, scrape or brush soil and debris from exterior surfaces to the extent practical.

