

Bayfield County Forestry & Parks Department

Forester: Caleb E. Brown			Compartment: 88	Stand: 6	Tract Number: 46-18
Twp: T49N	Range: R8W	Sec: 27	Township: Orienta	Contract Number:	
Topography: Level & Gentle Rolling			Reforestation Code: Natural	Soil: Loamy Sand & Sand	Acres: 46

Estimated Volumes				*Approximately 97% red oak 2% basswood 4%, 1% other hardwood ** Approximately 52% white spruce, 47% balsam fir, 1% other conifer
Species	4" Roundwood (Cords)	Whole Tree (Tons)	Sawlogs (MBF)	
Red Oak*	491	1624	-	
Balsam Fir**	30	98	-	
Red Oak*	-	-	82	

Notes

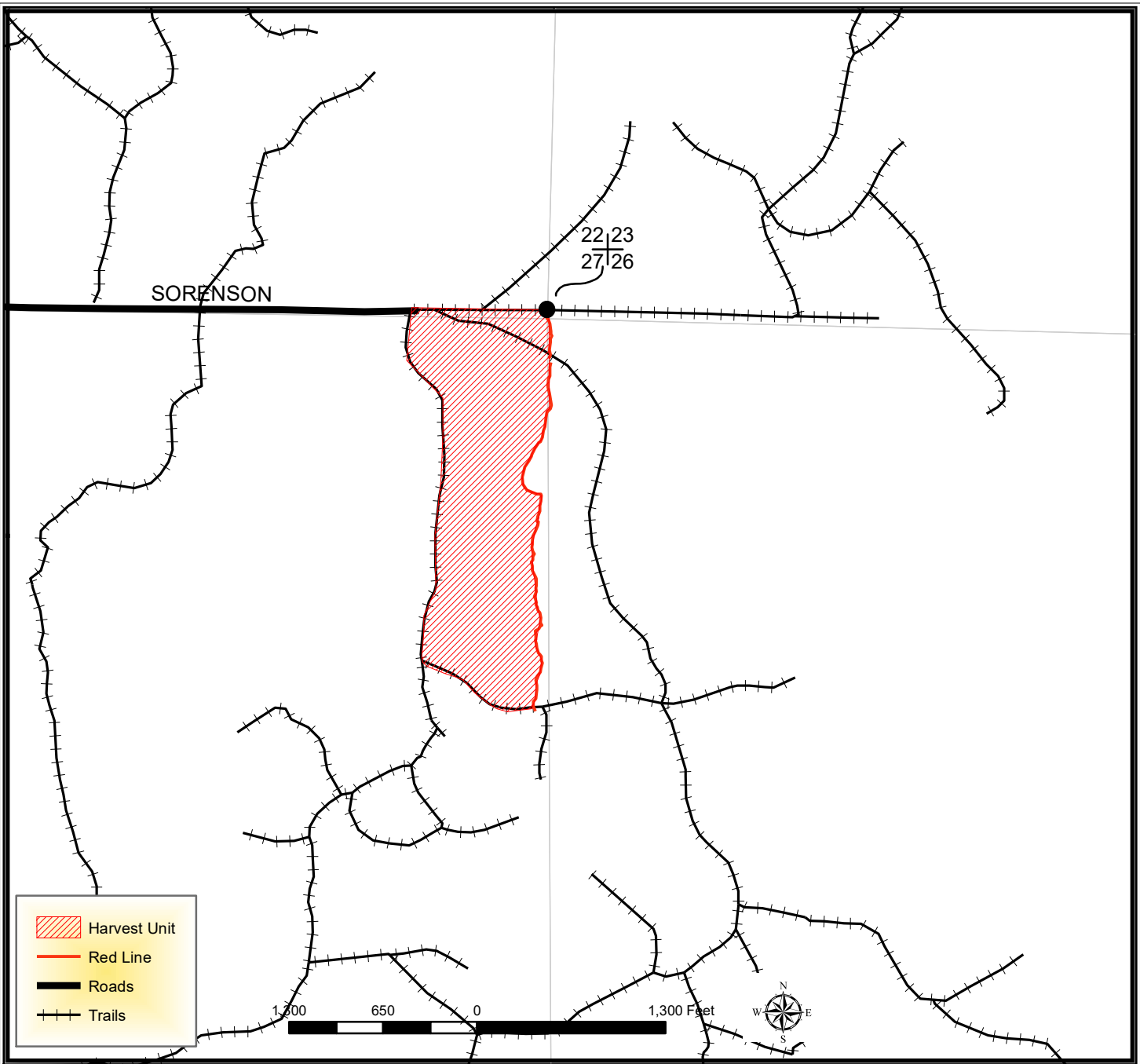

TRACT 46-18 – SUPPLEMENTAL REQUIREMENTS

The following terms and conditions supplement those provided in the Bayfield County Timber Sale Contract.

A. PRESCRIPTION:

1. Harvest unit is a overstory removal prescription with a residual seed tree with an estimated average residual basal area of 3 ft².

B. HARVESTING REQUIREMENTS:

1. Harvest all hardwood stems 4 inches and greater not marked with purple paint.
2. Harvest all conifer 4 inches and greater but leave all white pine, red pine, cedar, and hemlock.

C. OPERATIONAL REQUIREMENTS AND SEASONAL RESTRICTIONS:

1. Sale boundaries consist of red paint line and trails.
2. If harvest will utilize the whole tree, 1 in 10 tops must be left scattered throughout the sale.
3. Do not cut snags except for individuals that pose a safety hazard
4. Do not damage any survey monumentation.
5. Care must be taken to reduced damage to existing advanced regeneration.
6. In 2018, oak wilt was officially confirmed in Bayfield County. Currently, this timber sale is located more than six miles away from the closest known infected tree. However, over the duration of this contract, additional infections could be discovered. If, over the duration of this contract, including extensions, oak wilt is officially confirmed within a six mile radius of this timber sale, as determined by the county, the following seasonal restriction will be applied: no harvesting operations will be allowed between April 15 (or as otherwise determined by the county) and July 15.

D. ACCESS AND ROADS:

1. This contract requires County authorization for all road/landing construction and places a number of other requirements on road construction and closure.
2. Decking of wood along town roads will not be allowed without permission from Bayfield County.

E. OTHER:

1. To comply with Best Management Practices for Invasive Species: Prior to moving equipment onto or off the sale area, scrape or brush soil and debris from exterior surfaces to the extent practical.

