

# Bayfield County Forestry & Parks Department

Forester: <b>Neitzel</b>			Acres: <b>32</b>	Estimated Volumes		
Twp: <b>46N</b>	Range: <b>9W</b>	Sec: <b>11</b>	Compartment: <b>138</b>	Round Wood	Whole Tree	
Township: <b>Hughes</b>			Stand: <b>38</b>	Cords	Tons	
Soil: <b>Sand</b>	Reforestation Code: <b>N/A</b>		Tract Number: <b>26-17</b>	<b>Red Pine*</b>	<b>479</b>	<b>1539</b>
Topography: <b>Gentle Rolling</b>			Contract Number:	<b>* approx. 95% red pine and 5% jack pine</b>		

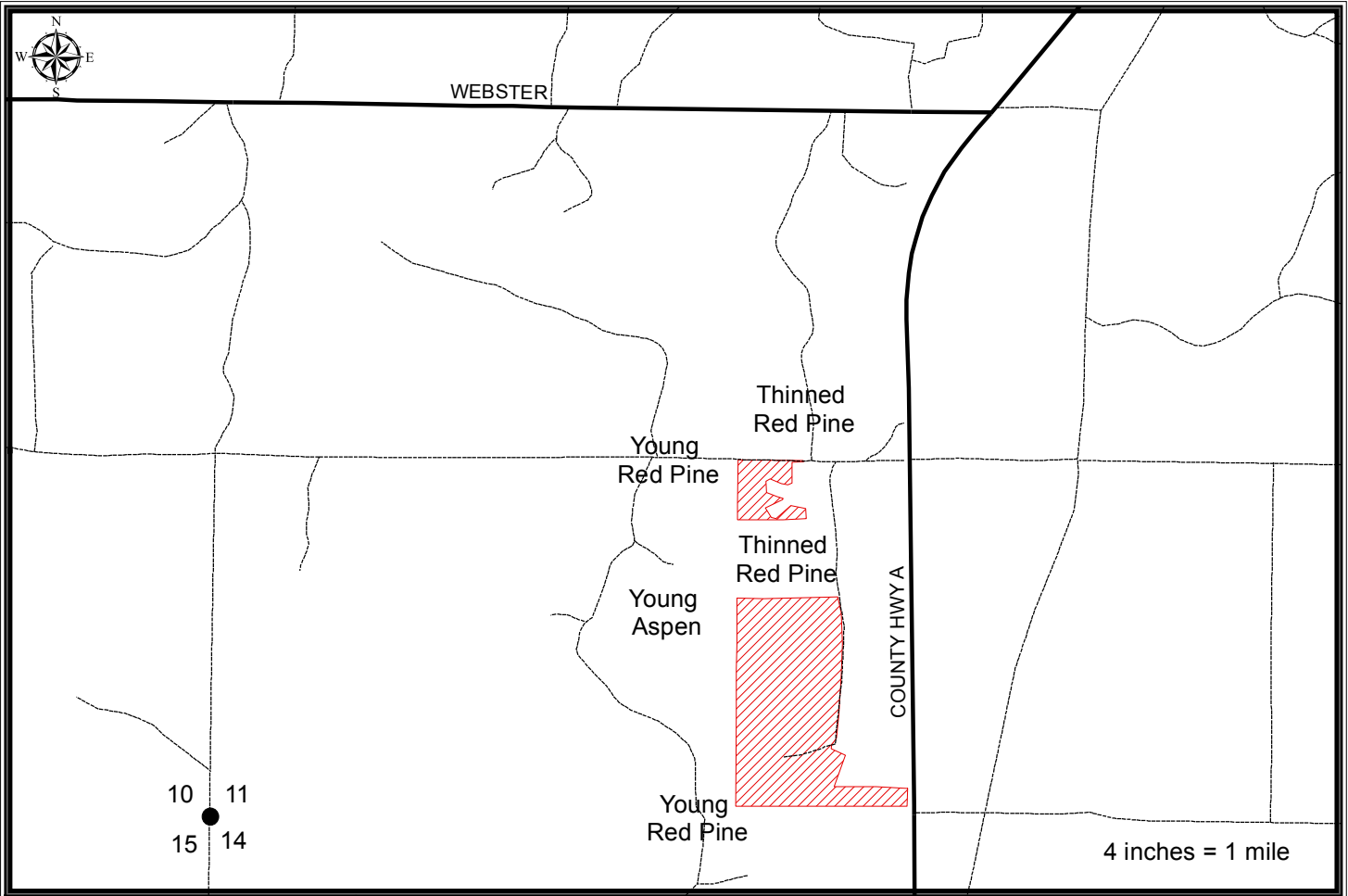

- Harvest Requirements:**
- Sale is a red pine thinning being sold on a Ticket Scale Basis
  - Sale boundaries consist of timber changes to previously thinned red pine, older red pine, younger red pine, young jack pine, aspen, roads and trails.
  - Cut all red pine in every third row (cut one row, leave two rows). Cut rows are not marked with paint. Logger will determine cut rows to the satisfaction of the Sale Administrator.
  - Harvested pine cannot be kept on the Bayfield County Forest for more than three weeks from May 1<sup>st</sup> to August 31<sup>st</sup>.
  - Do not cut snags except for those that pose a safety hazard.
  - To comply with the Best Management Practices for Invasive Species: Prior to moving equipment onto or off of the sale area, scrape or brush soil and debris from exterior surfaces to the extent practical.
  - According to the Bayfield County Access management plan the existing roads within this sale are open to highway vehicle use. Upon completion of the timber sale these roads will be left open unless otherwise directed by the sale administrator.
  - Decking of wood along town roads will not be allowed without permission from Bayfield County.
  - If harvest will utilize the whole tree, 1 in 10 tops must be left scattered throughout the sale.
  - This contract requires County authorization for all road/landing construction and places a number of other requirements on road construction and closure.