

# Bayfield County Forestry and Parks

Forester: Latvala / LeBouton			Acre: 145	Estimated Volumes:		
Twp: 46N	Range: 9W	Section: 27	Compartment: 148			
Township: Barnes			Stand: 18	Species	Round Wood Cords	Whole Tree Tons
Soil: Sand		Reforestation Code: Thinning	Tract Number: 43-17	*Red Pine	1,210	3490
Topography: Gently Rolling			Contract Number:	*Red Pine includes 93% red pine, 6% jack pine & 1% misc.		

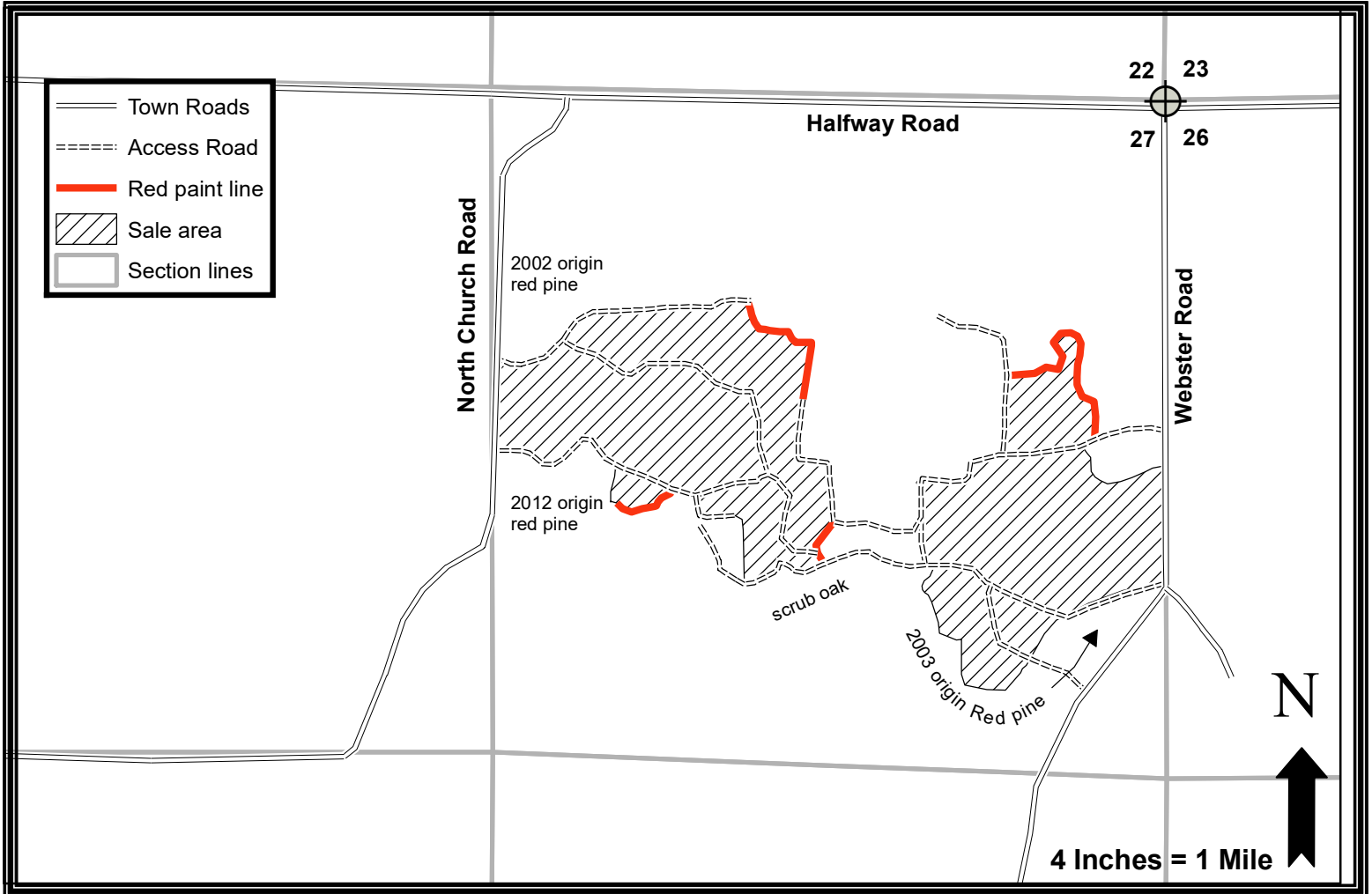

## Harvest requirements:

- This timber sale is being sold on a ticket scale basis.
- This is a first thin red pine plantation with an average diameter of 8 inches.
- Harvested pine cannot be kept on the Bayfield County Forest for more than three weeks from May 1<sup>st</sup> to August 31<sup>st</sup>.
- Logger select, cut all trees in every third row. The harvest pattern should leave two rows and take one row. No damage to residual rows will be allowed.
- No damage to residual trees will be tolerated.
- To comply with the Best Management Practices for Invasive Species, prior to moving equipment on to or off the sale area, scrape or brush debris and soil from exterior surfaces to the greatest extent possible.
- The existing access roads within this timber sale are open to highway vehicle use. Upon completion of the timber sale these roads will be left open and in good condition, unless otherwise directed by the sale administrator.
- Decking of wood along town roads will not be allowed without the permission of Bayfield County.
- Sale boundaries are designated with red paint where indicated. Other boundaries are woods roads or forest type change.