

Bayfield County Forestry & Parks Department

Forester: O'Krueg, J. Neitzel, L. Neitzel			Acres: 37	Estimated Volumes									
Twp: 47	Range: 9W	Sec: 12	Compartment: 109										
Township: Hughes			Stand: 14,3	<table border="1"> <thead> <tr> <th rowspan="2">Species</th> <th>Whole Tree</th> <th>Round Wood</th> </tr> <tr> <th>Tons</th> <th>Cords</th> </tr> </thead> <tbody> <tr> <td>Red Pine</td> <td>1191</td> <td>402</td> </tr> </tbody> </table>		Species	Whole Tree	Round Wood	Tons	Cords	Red Pine	1191	402
Species	Whole Tree	Round Wood											
	Tons	Cords											
Red Pine	1191	402											
Soil: Sand	Reforestation Code: NA	Tract Number: 02-16		*Approx. 80% Red Pine, 19% Austrian Pine, 1% Hardwood									
Topography: Gently Rolling		Contract Number:											

Average diameter is 10 inches

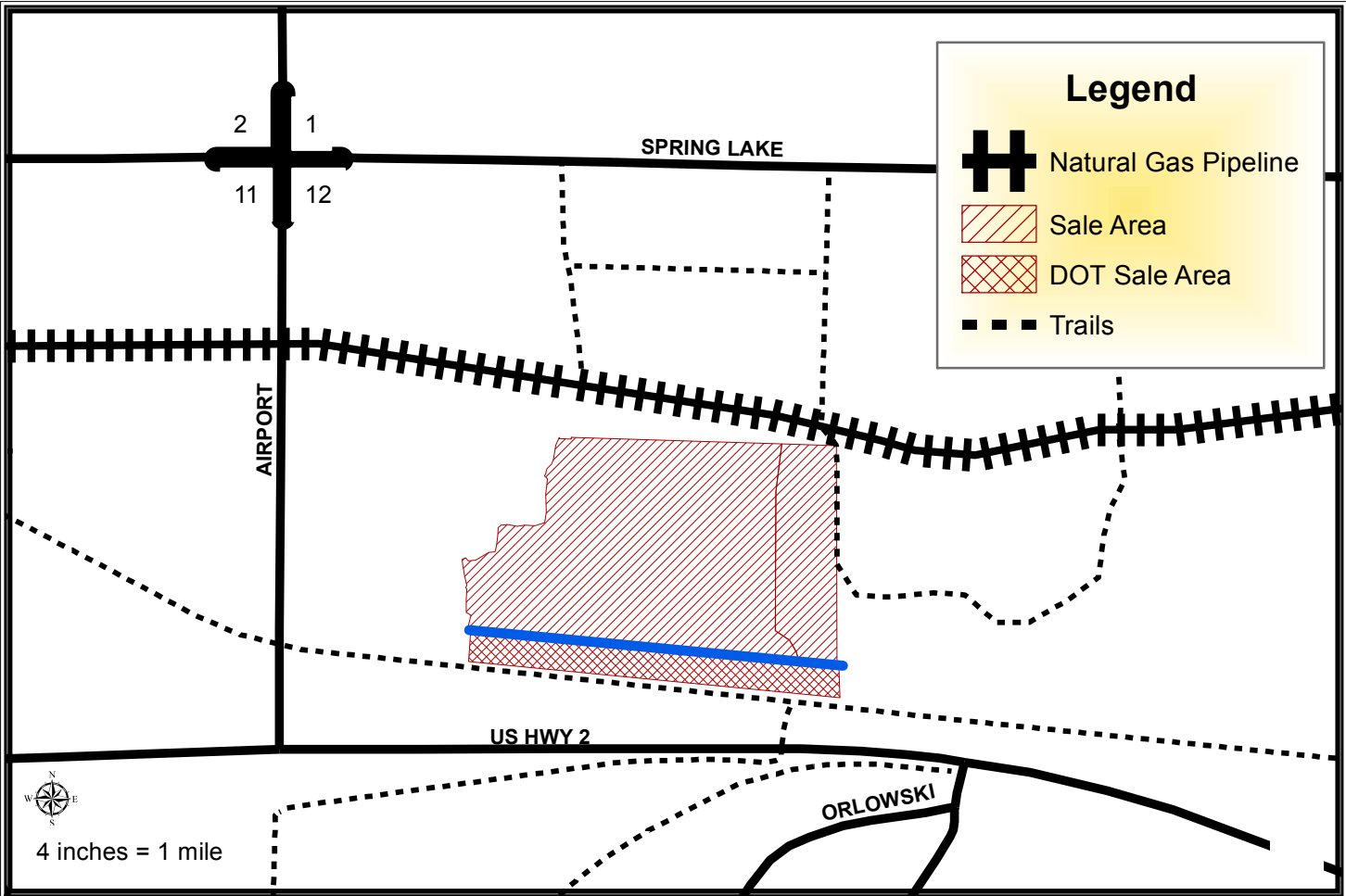

Harvest Requirements:

- Sale is a red pine thinning being sold on a Ticket Scale Basis
- Sale boundaries consist of red paint line or noticeable change in timber type.
- Harvest all trees marked with orange paint, leave all blue painted trees.
- The area south of the blue line that is being cut is Wisconsin DOT property. Bayfield County has made all arrangements with the DOT and we will be administering the sale on their behalf.
- Hauling or decking of wood along the Tri-County Corridor will not be allowed without permission from the Tri-County Corridor Commission and/or the Wisconsin DOT.
- If the Natural Gas pipeline needs to be crossed, Digger's hotline must mark the line and the pipeline company must be contacted prior to crossing. The pipeline company may place conditions on crossing the line. In the past they have requested that a soil lift be used where the road crosses the line.
- Harvested pine cannot be kept on the Bayfield County Forest for more than three weeks from May 1st to August 31st.
- Do not cut snags except for those that pose a safety hazard.
- To comply with the Best Management Practices for Invasive Species: Prior to moving equipment onto or off of the sale area, scrape or brush soil and debris from exterior surfaces to the extent practical.
- Decking of wood along town roads will not be allowed without permission from Bayfield County.
- If harvest will utilize the whole tree, 1 in 10 tops must be left scattered throughout the sale.
- This contract requires County authorization for all road/landing construction and places a number of other requirements on road construction and closure.
