

Bayfield County Forestry and Parks

Forester: E. Sirrine			Acres: 90	Estimated Volumes:						
Twp: 50N	Range: 6W	Section: 14 & 23	Compartment: 27	<table border="1"> <thead> <tr> <th>Species</th> <th>Whole Tree Tons</th> </tr> </thead> <tbody> <tr> <td>Mixed Hardwood*</td> <td>4294</td> </tr> <tr> <td>Fir/Spruce^</td> <td>1349</td> </tr> </tbody> </table>	Species	Whole Tree Tons	Mixed Hardwood*	4294	Fir/Spruce^	1349
Species	Whole Tree Tons									
Mixed Hardwood*	4294									
Fir/Spruce^	1349									
Township: Bell			Stand: 8, 10							
Soil: Silt loam		Reforestation Code: Natural	Tract Number: 26-16	*Contains 53% Aspen, 22% Maple, 14% Ash, 11% Birch						
Topography: Flat, slight slopes		4"= 1 Mile	Contract Number:	^Contains 90% Fir, 10% Spruce						

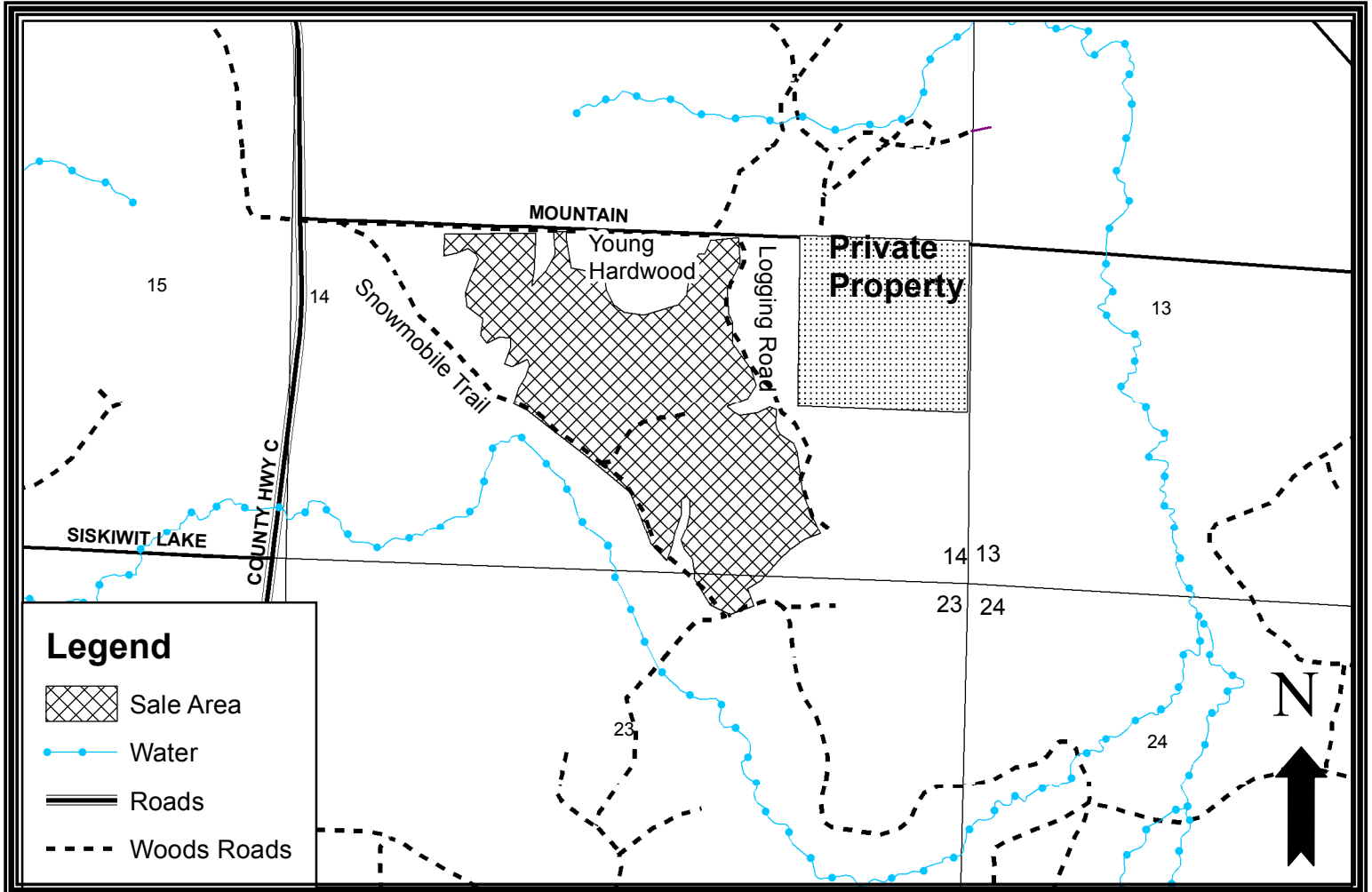

Harvest requirements:

- This is a ticket sale.
- This is required to be whole tree harvested. 1 in 10 tops must be left on site.
- Boundary is marked in red paint. Young hardwoods will form boundary on North end of sale.
- Harvest will be limited to dry or frozen ground conditions.
- Cut all aspen, maple, birch, ash, balsam fir, and spruce 1" and larger
- LEAVE all red oak, white pine, red pine, hemlock, and cedar.
- Do not damage any survey monumentation.
- Prior to moving equipment on to or off the sale area, scrape or brush debris and soil from exterior surfaces.
- Do not cut snags except those that pose a safety hazard to logging operations.
- All roads are in place. Logging road on east side of sale will be preferred access. This contract requires county authorization for all road/landing construction and places a number of other requirements on road construction and closure.
- Decking of wood along town roads will not be allowed without permission of Bayfield County.
- During winter harvesting the snowmobile trail must be kept unobstructed and in a packed snow condition. The purchaser must insure that harvesting and hauling operations will not create a safety hazard to snowmobiles.