

# Bayfield County Forestry & Parks Department

Forester: Neitzel			Acres: 143	Estimated Volumes																					
Twp: 47N	Range: 9W	Sec: 8	Compartment: 104																						
Township: Hughes			Stand: 1 and 6	<table border="1"> <thead> <tr> <th rowspan="2">Species</th> <th>Whole Tree</th> <th>Round Wood</th> <th>Logs</th> </tr> <tr> <th>Tons</th> <th>Cords</th> <th>MBF</th> </tr> </thead> <tbody> <tr> <td>Red Oak</td> <td>2187</td> <td>699</td> <td>205*</td> </tr> <tr> <td>Mixed Hardwood</td> <td>215</td> <td>66*</td> <td></td> </tr> <tr> <td>Aspen</td> <td>89</td> <td>28</td> <td></td> </tr> </tbody> </table> <p>* approx. 70% maple, 22% white birch, 9% basswood, 1% other hardwood. ** approx. 95% red oak and 5% other hardwood</p>			Species	Whole Tree	Round Wood	Logs	Tons	Cords	MBF	Red Oak	2187	699	205*	Mixed Hardwood	215	66*		Aspen	89	28	
Species	Whole Tree	Round Wood	Logs																						
	Tons	Cords	MBF																						
Red Oak	2187	699	205*																						
Mixed Hardwood	215	66*																							
Aspen	89	28																							
Soil: Sandy Loam	Reforestation Code: Nat.	Tract Number: 36-16	Contract Number:																						
Topography: Gentle Rolling																									

**The Goal Of This Sale Is To Release Advanced Regeneration.  
Minimize Damage To Existing Regeneration In The Overstory Removal Unit**

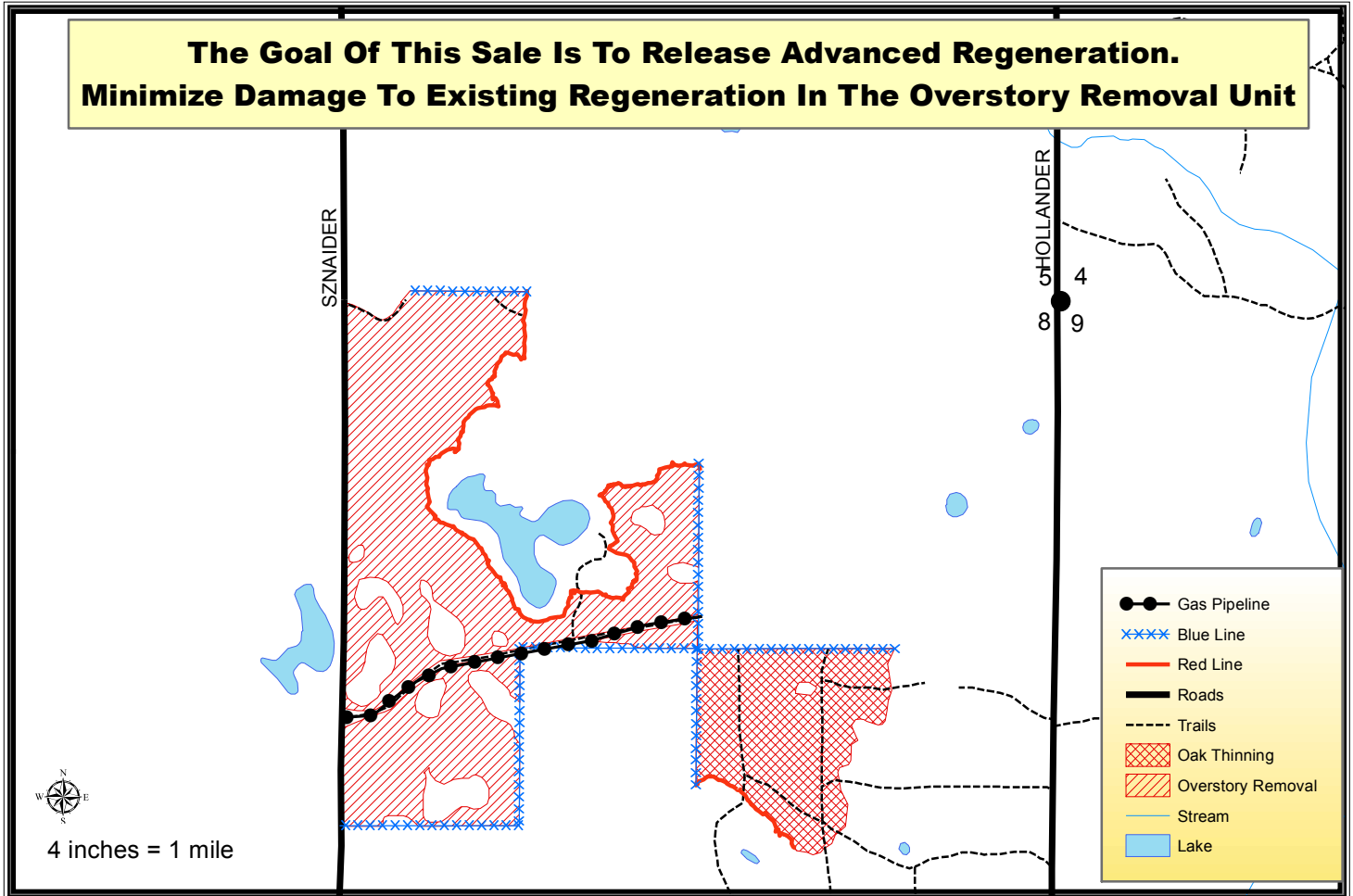

## Harvest Requirements:

- Sale is an overstory removal and an oak thinning being sold on a Ticket Scale Basis.
- **Overstory Removal Unit: No sale operations will be allowed between April 1<sup>st</sup> and September 31<sup>st</sup>.**
- **Thinning Unit: From May 19<sup>th</sup> to October 16<sup>th</sup> care should be taken to avoid open sandy areas with equipment and felled trees due to the possible presence of a rare animal.**
- Sale boundaries consist of red paint line, blue paint line, a road and an abrupt timber type change to young aspen.
- Overstory removal: Harvest all merchantable hardwoods stems. Leave all merchantable conifer. **Damage to regeneration must be minimized.**
- Thinning: Harvest all orange marked trees. Care must be taken to minimize the damage to the residual stand.
- The access road crosses a Natural Gas pipeline as noted on the map. Digger's hotline must mark the line and the pipeline company must be contacted prior to crossing. The contractor is responsible for contacting Digger's hotline and the pipeline company. The pipeline company may place conditions on crossing the line. In the past they have requested that soil lift be used where the road crosses the line
- Do not cut snags except for those that pose a safety hazard.
- To comply with the Best Management Practices for Invasive Species: Prior to moving equipment onto or off of the sale area, scrape or brush soil and debris from exterior surfaces to the extent practical.
- Decking of wood along town roads will not be allowed without permission from Bayfield County.
- If harvest will utilize the whole tree, 1 in 10 tops must be left scattered throughout the sale.
- This contract requires County authorization for all road/landing construction and places a number of other requirements on road construction and closure.
- The blue line indicates private property. No equipment or felled trees may cross the line.
- This map is not a survey of the actual boundary of any property this map depicts.
- Do not damage any survey monumentation