

Bayfield County Forestry and Parks

Forester: Golembiewski			Acres: 94	Estimated Volumes:	
Twp: 45N	Range: 9W	Section: 10	Compartment: 163	Species	Round Wood Cords
Township: Barnes			Stand: 12	Red Pine*	785
Soil: Sand	Reforestation Code: Thinning		Tract Number: 37-16	Aspen**	55
Topography: Gently Rolling			Contract Number:	*Red Pine includes 98% Red Pine & 2% Jack Pine. **Aspen includes 91% Aspen & 9% Scrub Oak.	

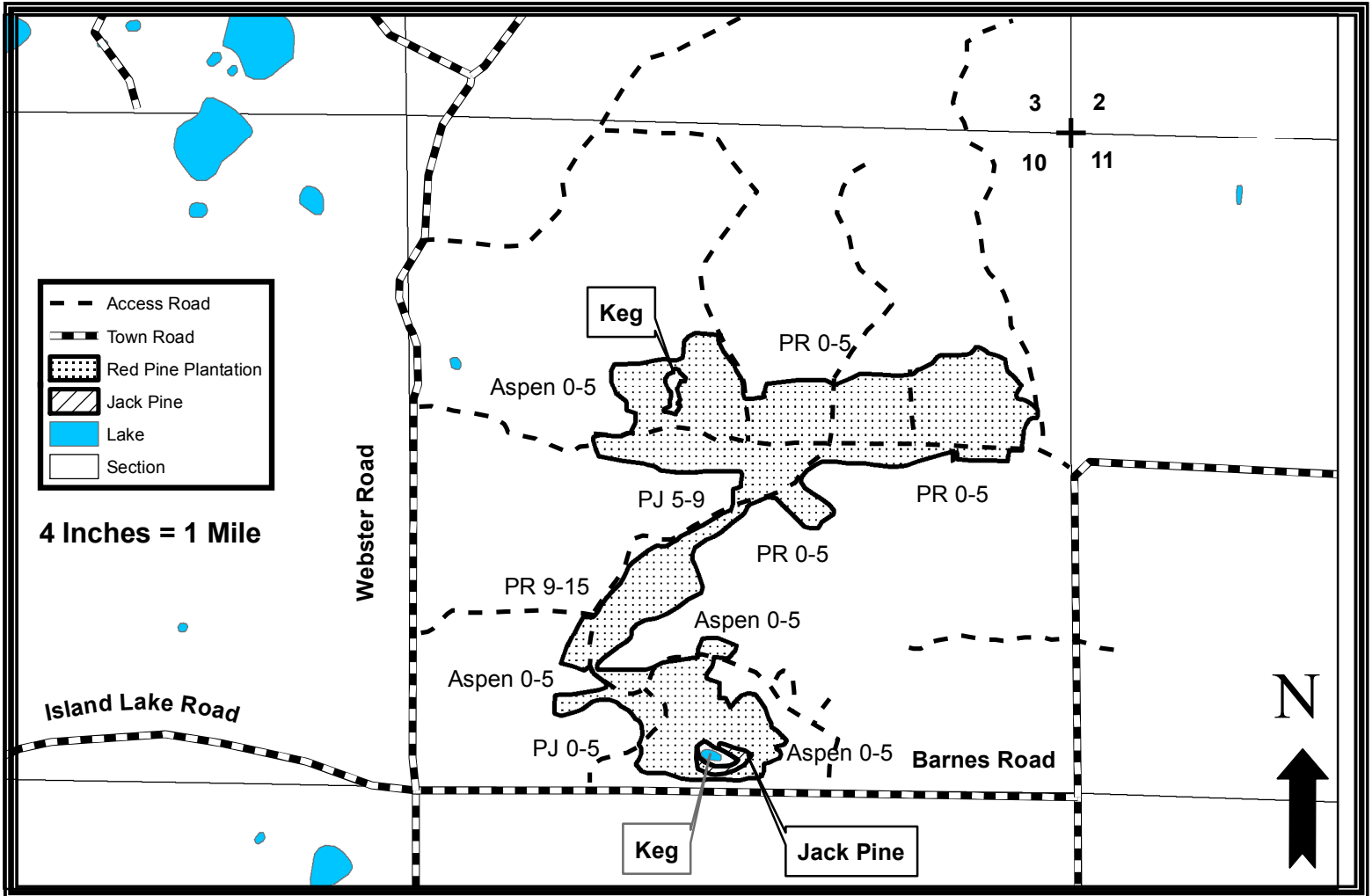

Harvest requirements:

- This timber sale is being sold on a ticket scale basis.
- This is a first thin red pine plantation with an average diameter of 8 inches.
- This sale is restricted to short-wood harvesting operations. Bayfield County may, at its discretion, allow pole skidding if the purchaser can demonstrate that it can be done without causing damage to the residual stand.
- Logger select, cut all trees in every third row.
- Cut all Red Pine, Jack Pine, Aspen and Scrub Oak within cut rows, and utilize to a 4-inch top diameter.
- Cut all large diameter natural Red Pine that are scattered throughout the sale area that can be harvested without damaging the uncut rows.
- Cut all large mature Jack Pine which exists in one small pocket within the plantation.
- Leave all young aspen and young jack pine pockets within the sale area undamaged.
- To comply with the Best Management Practices for Invasive Species, prior to moving equipment on to or off the sale area, scrape or brush debris and soil from exterior surfaces to the greatest extent possible.
- The existing access roads within this timber sale are open to highway vehicle use. Upon completion of the timber sale these roads will be left open and in good condition, unless otherwise directed by the sale administrator.
- Decking of wood along town roads will not be allowed without permission of Bayfield County.
- Harvested pine cannot be kept on the Bayfield County Forest for more than three weeks from May 1st to August 31st.
- Sale boundaries are marked with Red Paint or natural type change.