

# Bayfield County Forestry & Parks Department

Forester: J. Neitzel, L. Neitzel			Acre: 36	<table border="1"> <thead> <tr> <th colspan="4">Estimated Volumes</th> </tr> <tr> <th>Species</th> <th>Whole Tree</th> <th>Round Wood</th> <th>Logs</th> </tr> </thead> <tbody> <tr> <td>Mixed Hardwood</td> <td>2617*</td> <td>803</td> <td>29**</td> </tr> <tr> <td>Aspen</td> <td>170</td> <td>62</td> <td></td> </tr> <tr> <td>Basswood</td> <td>207</td> <td>72</td> <td>8</td> </tr> <tr> <td>Red Oak</td> <td>224</td> <td>63</td> <td>23</td> </tr> <tr> <td>Balsam fir</td> <td>152***</td> <td>39</td> <td></td> </tr> </tbody> </table>			Estimated Volumes				Species	Whole Tree	Round Wood	Logs	Mixed Hardwood	2617*	803	29**	Aspen	170	62		Basswood	207	72	8	Red Oak	224	63	23	Balsam fir	152***	39	
Estimated Volumes																																		
Species	Whole Tree	Round Wood	Logs																															
Mixed Hardwood	2617*	803	29**																															
Aspen	170	62																																
Basswood	207	72	8																															
Red Oak	224	63	23																															
Balsam fir	152***	39																																
Twp: 50N	Range: 4W	Sec: 4	Compartment: 16																															
Township: Bayfield			Stand: 11																															
Soil: Clay, Silty/Sandy/Red Clays		Reforestation Code: NR	Tract Number: 13-15																															
Topography: Gentle Rolling			Contract Number:																															

\* approx. 77% Maple, 13% Yellow Birch, 7% Ash, 2% White Birch, 1% Other Hardwood  
 \*\* approx. 59% Maple, 37% Yellow Birch, 3% White Birch, 1% Other Hardwood  
 \*\*\* approx. 85% Balsam Fir, 15% Spruce

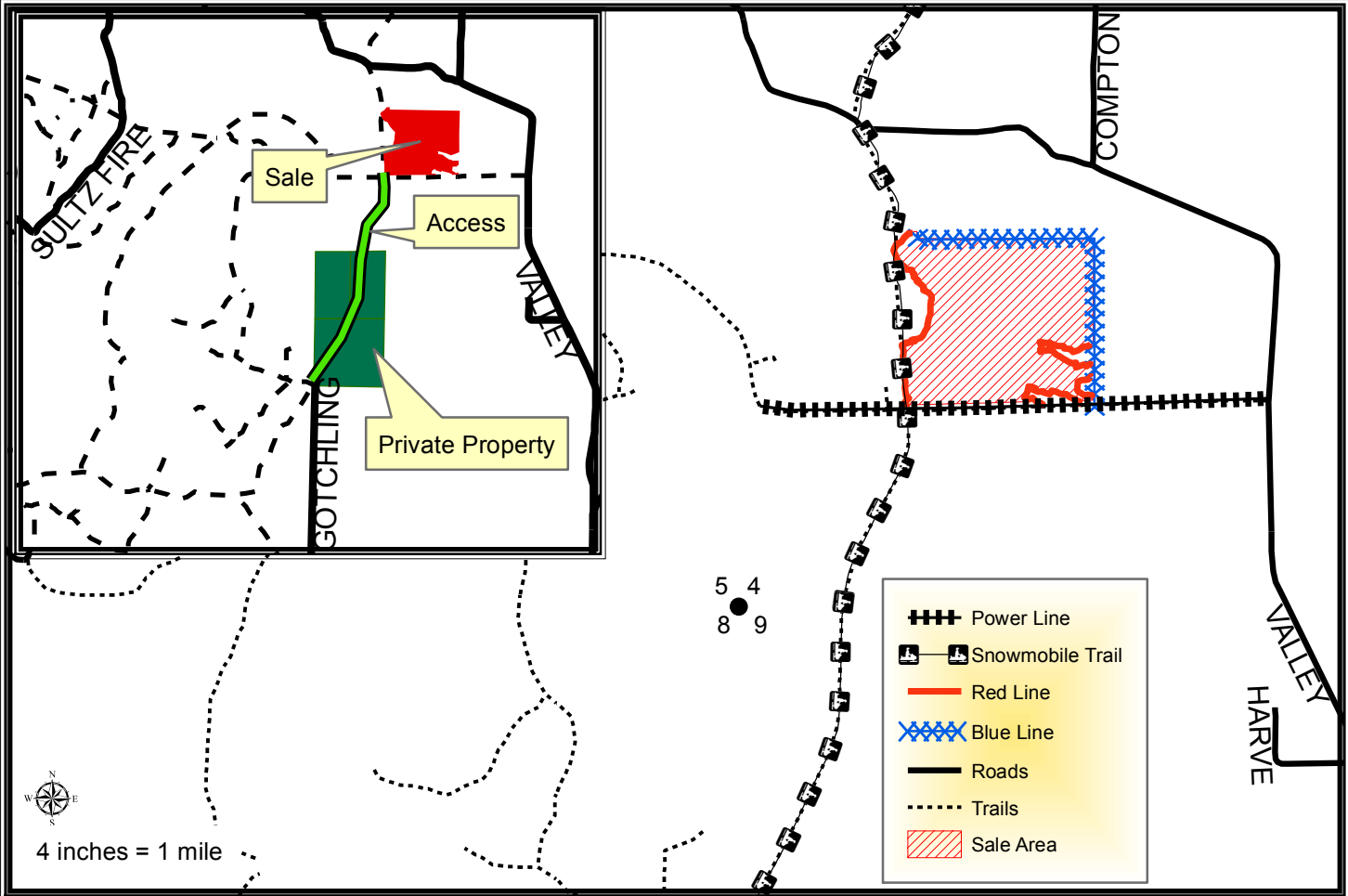

## Harvest Requirements:

- Sale is a clearcut being sold on a Ticket Scale Basis
- Harvest all merchantable hardwood except trees marked with purple paint. Harvest all merchantable conifer except hemlock and cedar.
- Sale boundaries consist of red paint line, blue paint line and a power line right-of-way.
- The blue paint line indicates private property. No equipment or felled trees may cross the line.
- Sale operation may only occur when the ground is frozen unless written permission is granted by Bayfield County.
- During winter harvesting the snowmobile trail must be kept unobstructed and in a packed snow condition. The purchaser must insure that harvesting and hauling operations will not create a safety hazard to snowmobiles.
- Access on the preexisting road(snowmobile trail) through private property to the south of the sale has been secured.
- No hauling is allowed on Star Route during periods of unfrozen ground.
- There is a power line that borders the sale on the south side. Caution must be taken when working around the power line. No decking of wood will be allowed on the power line without written permission from Bayfield County.
- Do not cut snags except for those that pose a safety hazard.
- To comply with the Best Management Practices for Invasive Species: Prior to moving equipment onto or off of the sale area, scrape or brush soil and debris from exterior surfaces to the extent practical.
- Decking of wood along town roads will not be allowed without permission from Bayfield County.
- If harvest will utilize the whole tree, 1 in 10 tops must be left scattered throughout the sale.
- This contract requires County authorization for all road/landing construction and places a number of other requirements on road construction and closure.