

Bayfield County Forestry & Parks Department

Forester: J. Neitzel, A. O'Krueg			Acres: 46	<table border="1"> <thead> <tr> <th colspan="3">Estimated Volumes</th> </tr> <tr> <th rowspan="2">Species</th> <th>Whole Tree</th> <th>Round Wood</th> </tr> <tr> <th>Tons</th> <th>Cords</th> </tr> </thead> <tbody> <tr> <td>Aspen</td> <td>1743</td> <td>525</td> </tr> <tr> <td>Fir/Spruce*</td> <td>379</td> <td>90</td> </tr> <tr> <td>Mixed Hardwood**</td> <td>387</td> <td>117</td> </tr> <tr> <td>Oak***</td> <td>349</td> <td>99</td> </tr> </tbody> </table>			Estimated Volumes			Species	Whole Tree	Round Wood	Tons	Cords	Aspen	1743	525	Fir/Spruce*	379	90	Mixed Hardwood**	387	117	Oak***	349	99
Estimated Volumes																										
Species	Whole Tree	Round Wood																								
	Tons	Cords																								
Aspen	1743	525																								
Fir/Spruce*	379	90																								
Mixed Hardwood**	387	117																								
Oak***	349	99																								
Twp: 49N & 48N	Range: 8W	Sec: 34 and 3	Compartment: 92 and 94																							
Township: Orienta and Trip			Stand: 12 and 13																							
Soil: Silt Loam and Clay		Reforestation Code: Nat.	Tract Number: 17-15																							
Topography: Moderate Slopes			Contract Number:																							

* approx. 95% balsam fir and 5% spruce
 ** approx. 58% maple 20% ash, 12% white birch, 9% basswood, 1% other
 *** approx. 90% red oak and 10% white oak

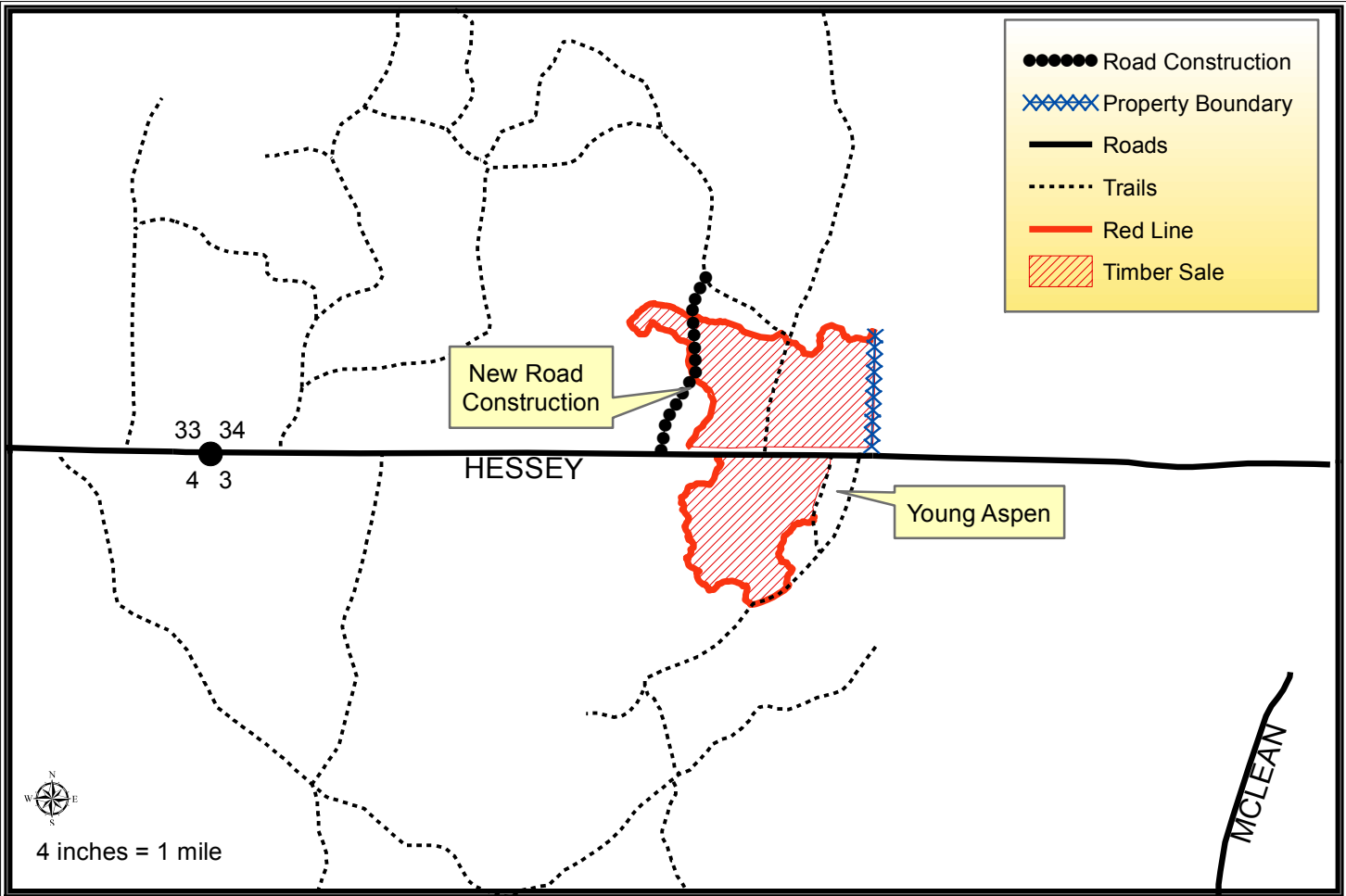

Harvest Requirements:

- Sale is a clearcut being sold on a Ticket Scale Basis
- Sale boundaries consist of red line, blue line, roads and noticeable type changes to young aspen.
- Blue line indicates private property. No equipment or felled trees may cross the line.
- Harvest all unmarked hardwood stems and merchantable spruce and balsam fir. Sever all non-merchantable hardwood stems 2" in diameter and greater.
- Leave all purple marked hardwood and all conifer except merchantable spruce and fir.
- This sale includes several trees that are painted with orange paint. Operator must fell and leave all trees marked with orange. Orange marked trees should be cut 5 ft. above ground level and should lie as close to the high stump as possible. These trees will create ruffed grouse drumming habitat.
- The County is requiring approximately 1,400 feet of new road to be constructed for this sale. Grade shaping, including crowning, ditching (including lead off ditches) and/or sloping, will be required as determined by the County. Road work must occur during non-frozen ground conditions.
- Sale operations may only occur when the ground is frozen unless written permission is granted by Bayfield County.
- Some portions of the sale may be harvested in the summer with new road construction.
- Do not cut snags except for those that pose a safety hazard.
- To comply with the Best Management Practices for Invasive Species: Prior to moving equipment onto or off of the sale area, scrape or brush soil and debris from exterior surfaces to the extent practical.
- Decking of wood along town roads will not be allowed without permission from Bayfield County.
- This contract requires County authorization for all road/landing construction and places a number of other requirements on road construction and closure.