

Bayfield County Forestry & Parks Department

Forester: Z. Neitzel			Acres: 53	<table border="1"> <thead> <tr> <th colspan="3">Estimated Volumes</th> </tr> <tr> <th>Species</th> <th>Tons</th> <th>Cords</th> </tr> </thead> <tbody> <tr> <td>Red Pine*</td> <td>1954</td> <td>712</td> </tr> </tbody> </table> <p>* Average Diameter is 12". Contains approximately 5% Jack Pine</p>			Estimated Volumes			Species	Tons	Cords	Red Pine*	1954	712
Estimated Volumes															
Species	Tons	Cords													
Red Pine*	1954	712													
Twp: 47N	Range: 9W	Sec: 19 and 30	Compartment: 114												
Township: Hughes			Stand: 1 and 19												
Soil: Loamy sand		Reforestation Code: N/A	Tract Number: 37-15												
Topography: Gentle rolling			Contract Number:												

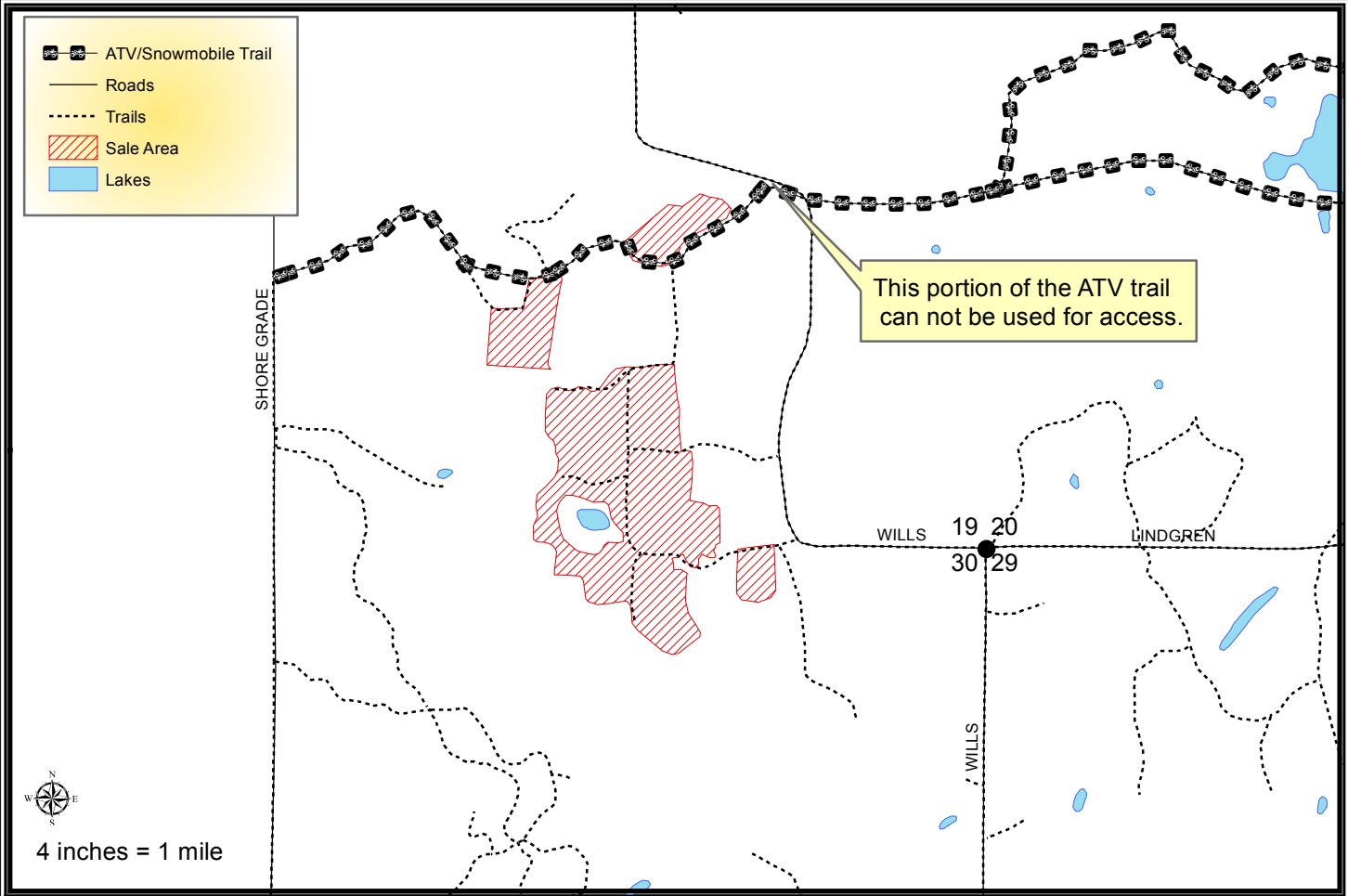

- Harvest Requirements:**
- Sale is a red pine thinning being sold on a Ticket Scale Basis
 - Harvest all orange marked trees and all jack pine within the plantation.
 - Sale boundaries are distinguishable by abrupt timber type changes to oak or aspen.
 - The portion of the ATV/Snowmobile trail from Wills road to the northern most stand is on private property and cannot be used to access the sale. However, the rest of the ATV/Snowmobile trail can be used.
 - Harvested pine cannot be kept on the Bayfield County Forest for more than three weeks from May 1st to August 31st.
 - Sale may be whole tree harvested but not whole tree skidded due to the possible damage to the residual trees. Short wood logging and pole skidding will be allowed if the purchaser can demonstrate that it can be done without causing damage to the residual stand.
 - During winter harvest the snowmobile trail must be kept unobstructed and in a packed snow condition. The purchaser must insure that harvesting and hauling operations will not create a safety hazard to snowmobiles.
 - During periods when no snow is present the ATV trail must be kept unobstructed. The purchaser must insure that harvesting and hauling operations will not create a safety hazard to ATV/UTVs.
 - Do not cut snags except for those that pose a safety hazard.
 - To comply with the Best Management Practices for Invasive Species: Prior to moving equipment onto or off of the sale area, scrape or brush soil and debris from exterior surfaces to the extent practical.
 - Decking of wood along town roads will not be allowed without permission from Bayfield County.
 - If harvest will utilize the whole tree, 1 in 10 tops must be left scattered throughout the sale.
 - This contract requires County authorization for all road/landing construction and places a number of other requirements on road construction and closure.