

Bayfield County Forestry and Parks Department

Forester: LeBouton			Compartment: 3	Stand: 4	Tract Number: 60-20
Twp: 51N	Range: 4W	Sec: 8,9	Township: Russell	Contract Number:	
Topography: Moderate			Reforestation Code: Natural regen	Soil: Sand mantled clay	Acres: 29

Estimated Volumes			
Species	Whole Tree (Tons)	4" Roundwood (Tons)	MBF
Red maple	*125	*105	++12
Oak			+5

* approximately 12% sugar maple and 88% red maple, and less than three cords each of aspen, ash, basswood, oak, and birch
 + approximately 50% maple, 25% basswood, 14% yellow birch, 9% white ash, and 2% white birch.
 ++approximately 12% hard maple and 88% red maple.

Notes: Harvest in frozen conditions only, as determined by Bayfield County.
Salvage Harvest, approx. 30% is damaged.
Contract expires May 31st, 2022. Harvesting not allowed after spring breakup, 2022.

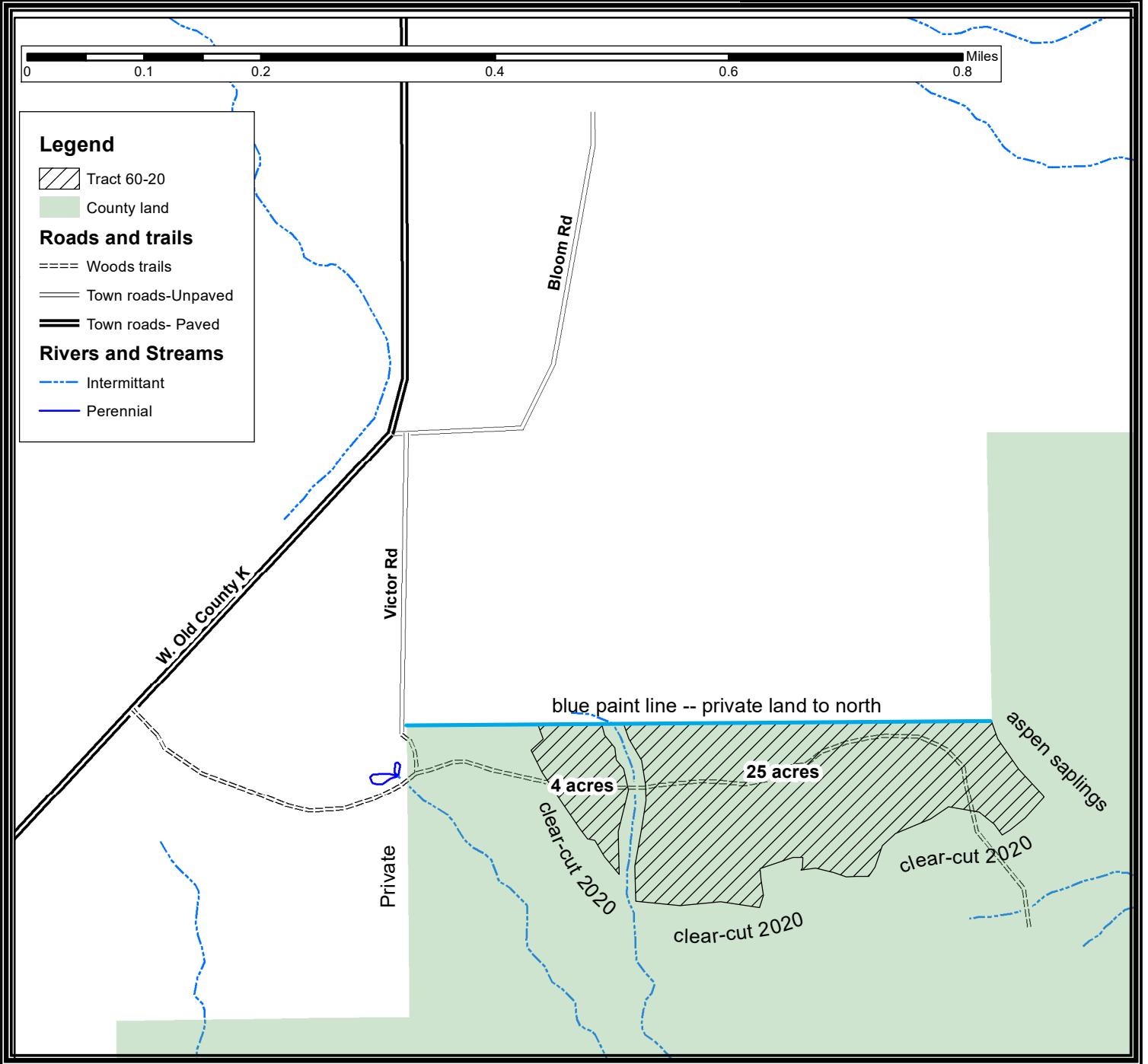

TRACT 60-20 – HARVEST REQUIREMENTS

The following terms and conditions supplement those provided in the Bayfield County Timber Sale Contract.

A. PRESCRIPTION:

1. Harvest wind-damaged trees. This will result in a seed tree harvest throughout much of the stand, with residual basal area of 30 to 40 sq.ft./acre.

B. HARVEST REQUIREMENTS

1. Harvest all blown-down trees. Harvested trees must be sufficiently root-sprung that the sale administrator will be able to tell from the stump that the tree had significant wind damage. The sale administrator may designate additional wind damaged trees that are broken off or have significant damage to the crown.
2. Leave all undamaged trees

C. OPERATIONAL REQUIREMENTS and SEASONAL RESTRICTIONS:

1. Harvest during frozen season only, as determined by Bayfield County.
2. Sale had a gap harvest completed in 2020. Ignore green and orange paint within sale boundaries.
3. Sale boundaries are the blue-painted private property line to the north; an aspen sapling stand to the east, and an aspen clear-cut harvest completed in 2020 to the south.
4. If harvest will utilize the whole tree, 1 in 10 tops must be left scattered throughout the sale.

D. ACCESS AND ROADS:

1. A frozen season haul road exists from the end of Victor Road through the sale area.
2. This contract requires County authorization for all road/landing construction and places a number of other requirements on road construction and closure.
3. The County has obtained permission to cross a narrow strip of private property at the end of Victory Lane in to the sale area.
4. Decking of wood along town roads will not be allowed without permission from Bayfield County.

E. OTHER:

1. To comply with Best Management Practices for Invasive Species: Prior to moving equipment onto or off the sale area, scrape or brush soil and debris from exterior surfaces to the extent practical.
2. Do not damage survey monumentation.
3. **This sale contract will expire on May 31st, 2021**

