

# Bayfield County Forestry and Parks Department

Forester: Krautkramer			Compartment: 28	Stand: 8	Tract Number: 10-21 Acres: 107
Twp: 50N	Range: 5&6W	Sec: 6, 1	Township: Bell	Contract Number:	
Topography: Level			Reforestation Code: Natural regen	Soil: Silt Loam	
Estimated Volumes				*Red Maple: 70% red maple, 20% ash, 5% white birch, 5% hard maple	
Species	Whole Tree (Tons)	4" Roundwood (Tons)	MBF		
Aspen	7500	5600		Notes: <b>3-year contract.</b> Harvest year-round, as determined by Bayfield County.	
Red Maple*	2821	1637			
Basswood	747	444			

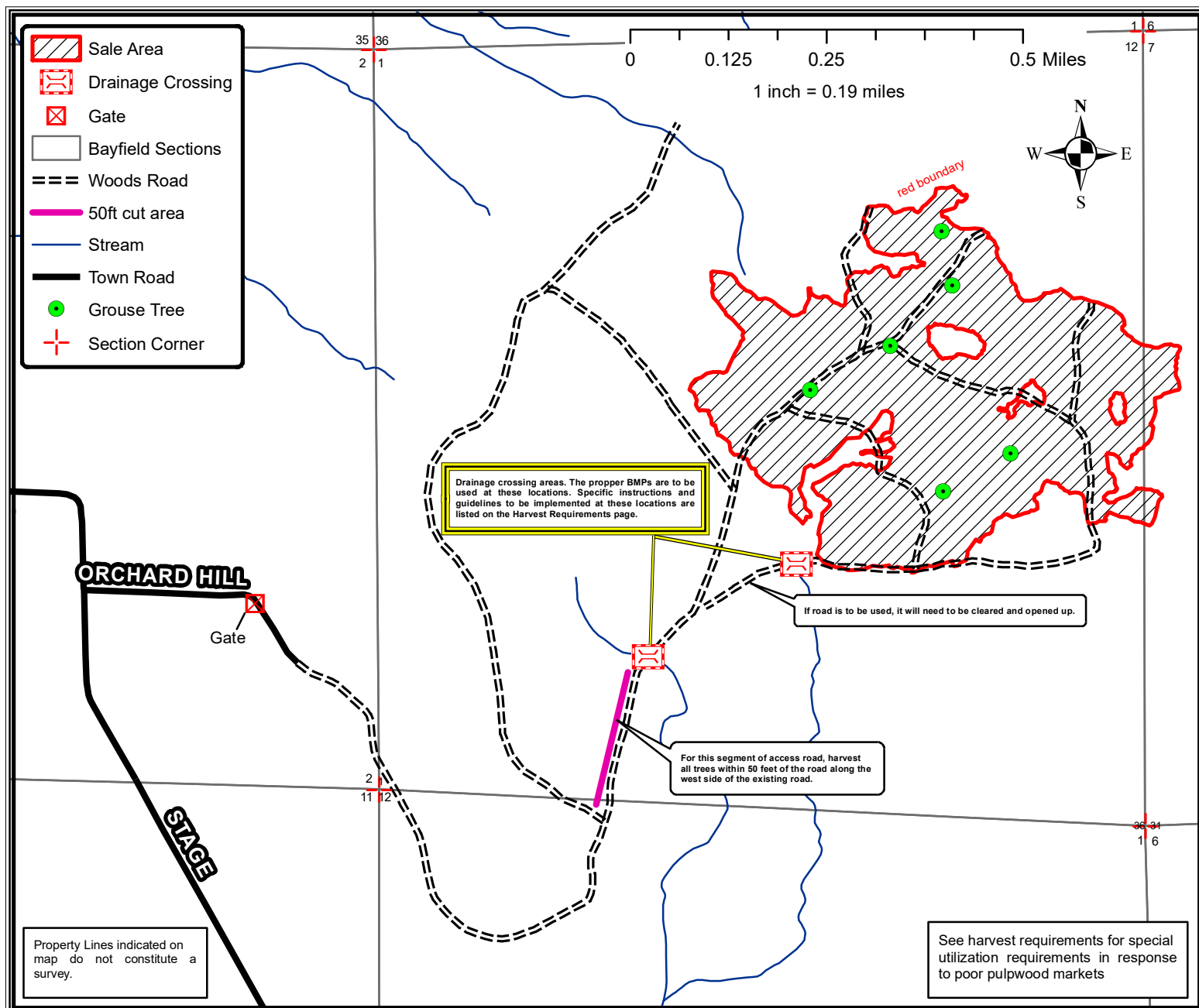

## TRACT 10-21 – HARVEST REQUIREMENTS

The following terms and conditions supplement those provided in the Bayfield County Timber Sale Contract.

### A. PRESCRIPTION:

- Aspen coppice harvest. The designated harvest area contains a residual area of 10%. This percent of the total area includes an RMZ, reserve islands, and red oak with a residual basal area of 5sq ft/acre.

### B. HARVEST REQUIREMENTS

- Cut all trees greater than 2" DBH, EXCEPT:
  - Red oak, white pine, white spruce, or cedar.
  - DO NOT HARVEST OR DAMAGE marked Riparian Management Zones and marked reserve islands.
  - Grouse trees are marked with purple paint. They are to be cut 5ft above ground and left in place next to the cut stump.

### C. OPERATIONAL REQUIREMENTS and SEASONAL RESTRICTIONS:

- Harvest can be done year-round, as determined by Bayfield County.
- Sale boundaries are red paint lines as indicated on map.
- RMZ boundaries are red paint lines as indicated on map.
- Reserve islands are red paint lines as indicated on map.
- If harvest will utilize the whole tree, 1 in 10 tops must be left scattered throughout the sale.

### D. ACCESS AND ROADS:

- For the segment of access road indicated on the map, harvest all trees within 50 feet of the road along the west side of the existing road.
- Drainage Crossing
  - A non-navigable drainage is identified on the map. A permanent 12" x 24' double wall smoothbore culvert will be installed at this location. Purchaser will supply the culvert.
  - Three additional 12" x 24' culverts may be needed along the widened area of the road. The purchaser may work with the sale administrator to determine if a rock bottom dip may be substituted for one or more of these culverts or if realigning the road could eliminate one or more of the culverts. If the sale administrator determines rock or culverts are necessary, the purchaser will supply them
  - If the road on the south side of the stand is to be used, the same type and size culvert listed above will be installed to cross the non-navigable drainage. Purchaser will supply the culvert.
- This contract requires County authorization for all road/landing construction and places other requirements on road construction and closure.
- Decking of wood along town roads will not be allowed without permission from Bayfield County.

### E. OTHER:

- To comply with Best Management Practices for Invasive Species: Prior to moving equipment onto or off the sale area, scrape or brush soil and debris from exterior surfaces to the extent practical.
- Utilization specification is to a 4" top. However, if the County determines that pulpwood markets continue to be very poor at the time of harvest the County will sign a contract amendment with the purchaser changing the utilization specification to a 5" top for selected species. When determining condition of the market, the County will pay attention to the amount of wood being purchased by the mills in Wisconsin Rapids and any other significant shifts in wood demand.

