

Bayfield County Forestry and Parks Department

Forester: Coonen			Compartment: 153	Stand: 7	Tract Number: 41-21 Acres: 68
Twp: 46N	Range: 9W	Sec:34	Township: Barnes	Contract Number:	
Topography: Gentle Rolling			Reforestation Code: None	Soil: Sand	

Estimated Volumes

Third thinning with average diameter of 10 inches.
*Volume Contains 99% Red Pine 1% misc.

Species	Whole Tree (Tons)	4" Roundwood (Tons)	Sawlogs (MBF)
Red Pine*	2025	1575	

Special Restrictions:
Harvested pine cannot be kept on Bayfield County Forest for more than three weeks from May 1st to August 31st

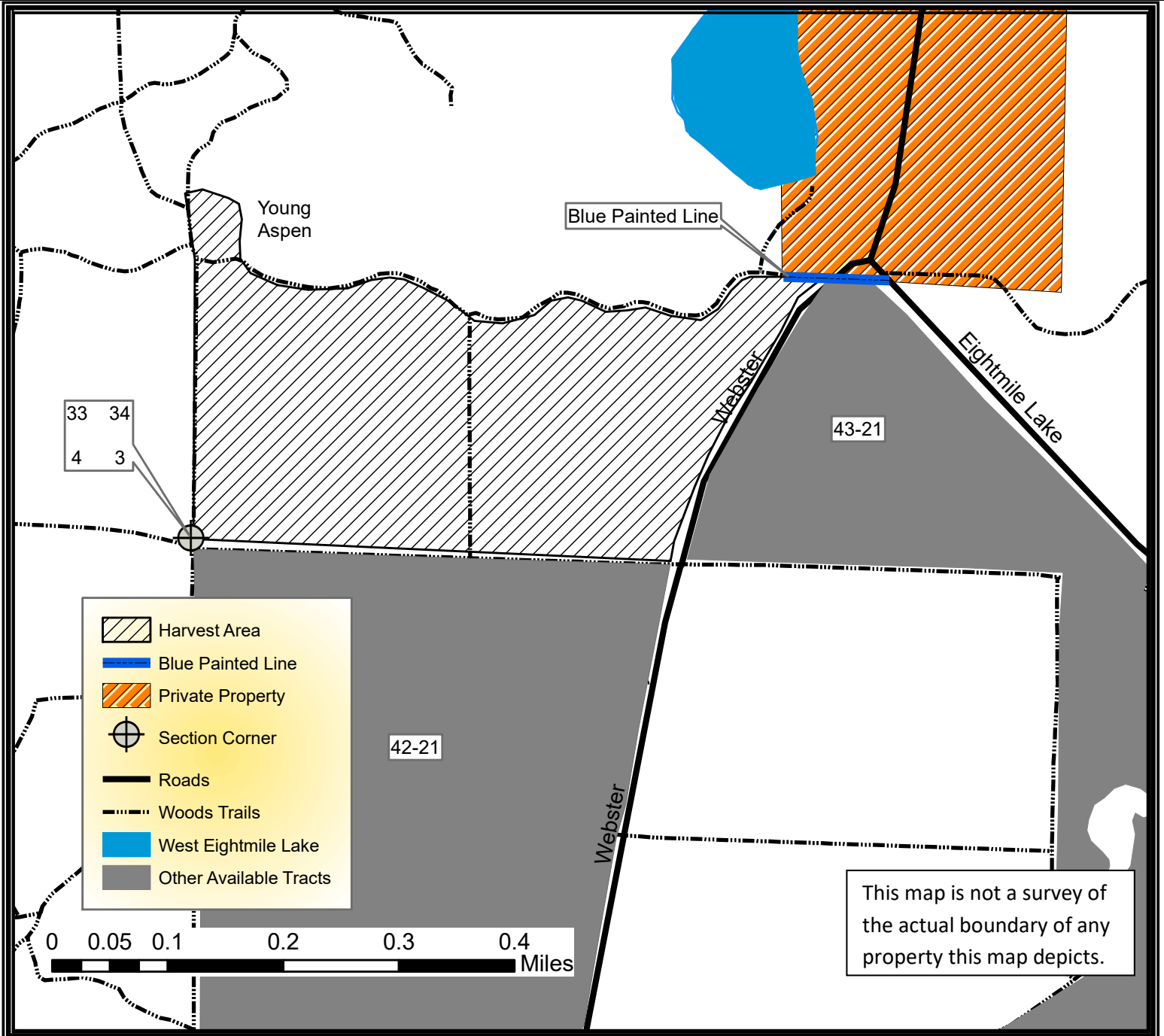

TRACT 41-21 – SUPPLEMENTAL REQUIREMENTS

The following terms and conditions supplement those provided in the Bayfield County Timber Sale Contract.

A. PRESCRIPTION:

1. The harvest unit has a thinning prescription with an estimated average residual basal area of 104 ft².

B. HARVEST REQUIREMENTS:

1. Harvest all orange marked trees.
2. Leave and avoid damage to all unmarked trees.

C. OPERATIONAL REQUIREMENTS AND SEASONAL RESTRICTIONS:

1. Sale boundaries consist of Webster Road, fuel break, young aspen, and timber trails.
2. Blue painted line indicates private property, no equipment or felled trees may cross this line.
3. If harvest will utilize the whole tree, 1 in 10 tops must be left scattered throughout the sale.
4. Harvested pine cannot be kept on the Bayfield County Forest for more than three weeks from May 1st to August 31st.
5. Do not cut snags except for individuals that pose a safety hazard.
6. Utilization specification is to a 4" top. However, if the County determines that pulpwood markets continue to be very poor at the time of harvest the County will sign a contract amendment with the purchaser changing the utilization specification to a 5" top for selected species. When determining condition of the market, the County will pay particular attention to the amount of wood being purchased by the mills in Wisconsin Rapids and any other significant shifts in wood demand.

D. ACCESS AND ROADS:

1. This contract requires County authorization for all road/landing construction and places a number of other requirements on road construction and closure.
2. Decking of wood along town roads will not be allowed without permission from Bayfield County.

E. OTHER:

1. To comply with Best Management Practices for Invasive Species: Prior to moving equipment onto or off the sale area, scrape or brush soil and debris from exterior surfaces to the extent practical.